

RECORDED 13 1997

# GRANT COUNTY U.S. PUBLIC LAND SURVEY MONUMENT RECORD

TYPE OF MONUMENT: City of Boscobel Aluminum  
TIES ARE AS INDICATED ON SKETCH

WITNESSES TO CORNER LOCATION

Sean M. Walsh  
Christopher G. Reedy  
\_\_\_\_\_  
\_\_\_\_\_

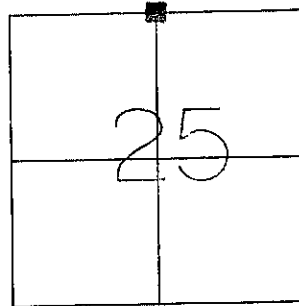

CORNER LOCATION  
North 1/4 Corner  
Section 25  
Town 8 North, Range 3 West  
Boscobel Township

### BASIS FOR MONUMENT LOCATION

In 1977 this corner was monumented and tied by L. Schmitt in conjunction with a survey for the City of Boscobel. Numerous other surveys in the vicinity called for a stone monument at this location.

I located a City of Boscobel Aluminum Monument at this location which fits the location previously occupied by the stone.

I found the ties shown hereon and perpetuated as shown.

I accepted this location as the only acceptable evidence and perpetuated.

This information is correct and true to the best of my knowledge and belief.

■ - City of Boscobel Aluminum Monument at Corner

● - 1/2" Iron Rod Found

Distances to the tree/spike ties were measured horizontally by taping.



### TIE SKETCH

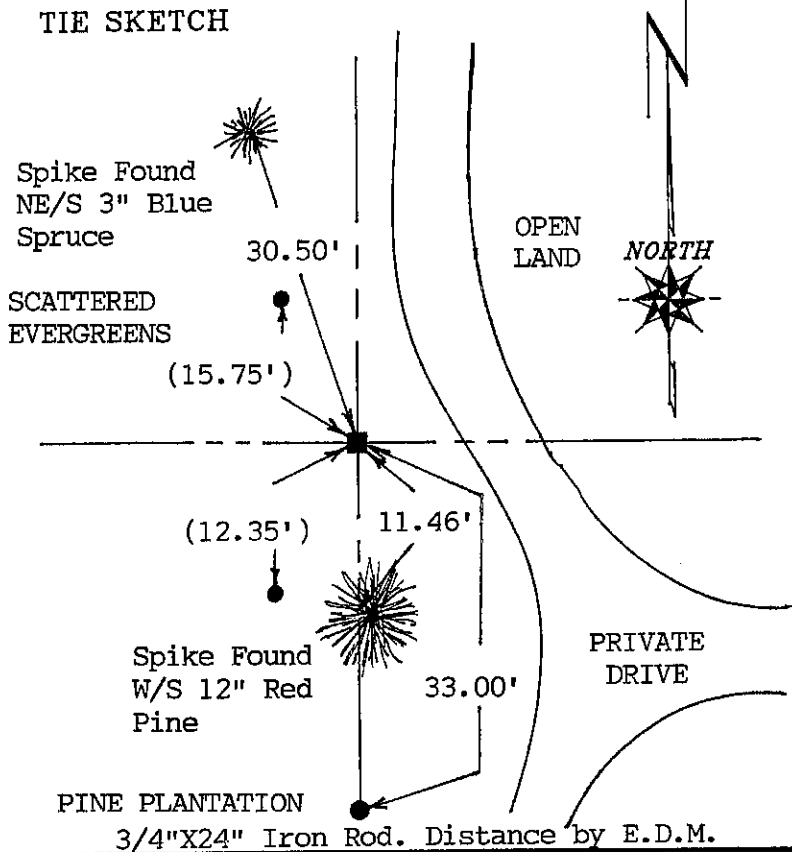

3/4"X24" Iron Rod. Distance by E.D.M.