

# U. S. PUBLIC LAND SURVEY MONUMENT RECORD

REC'D MAY 12 1997

**INSTRUCTIONS:**

This record shall show the location of the corner and shall include all of the following nine elements (a through i).

- (a) Identify the corner by reference to the U.S. public land survey system.

⊙ = Corner monument restored

Witness corner for West 1/4 corner of Section 24, T8N, R3W, 1088.06' South of West 1/4 corner on the West line of the SW1/4 of Section 24.

Date of Survey: April 8, 1997.

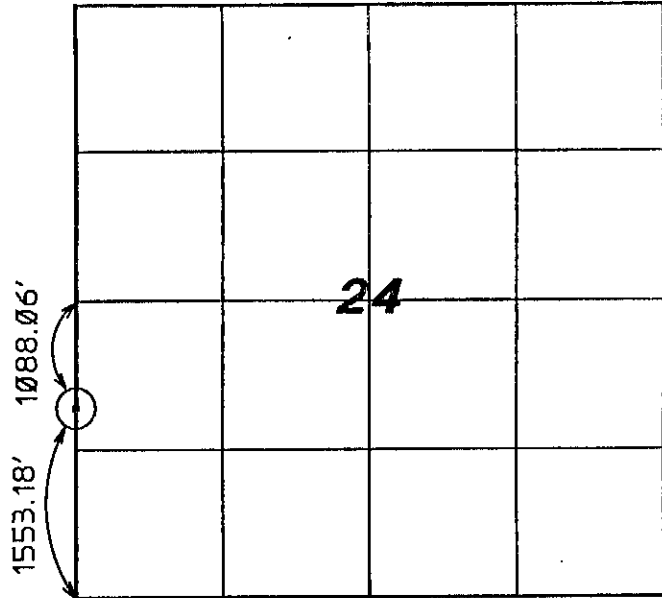

- (b) Describe any record evidence, monument evidence, occupational evidence, testimonial evidence or any other material evidence you considered, and whether the monument was found or placed.

I found a 1" iron pipe at the SW corner of Section 24 and several stakes along the West line of the SW1/4. I also found a 1" iron pipe at the East 1/4 corner and several stakes along the E-W 1/4 line. I computed the location of the West 1/4 corner as an intersection of these two lines. The corner falls in a marshy floodplain so I established the witness corner as shown.

- (c) In the plan view drawing below, provide reference ties to at least 4 witness monuments, or, if the location is within a municipality, to at least 2 witness monuments. (Witness monuments shall be made of concrete, natural stone, iron or other equally durable material.) Describe witness monuments.

- (d) Show a plan view drawing depicting the relevant monuments and reference ties which is sufficient in detail to enable accurate relocation of the corner monument if the corner monument is disturbed. Indicate north.

**LEGEND**

- ⊙ 1 1/4" REBAR SET
- 3/4" REBAR SET

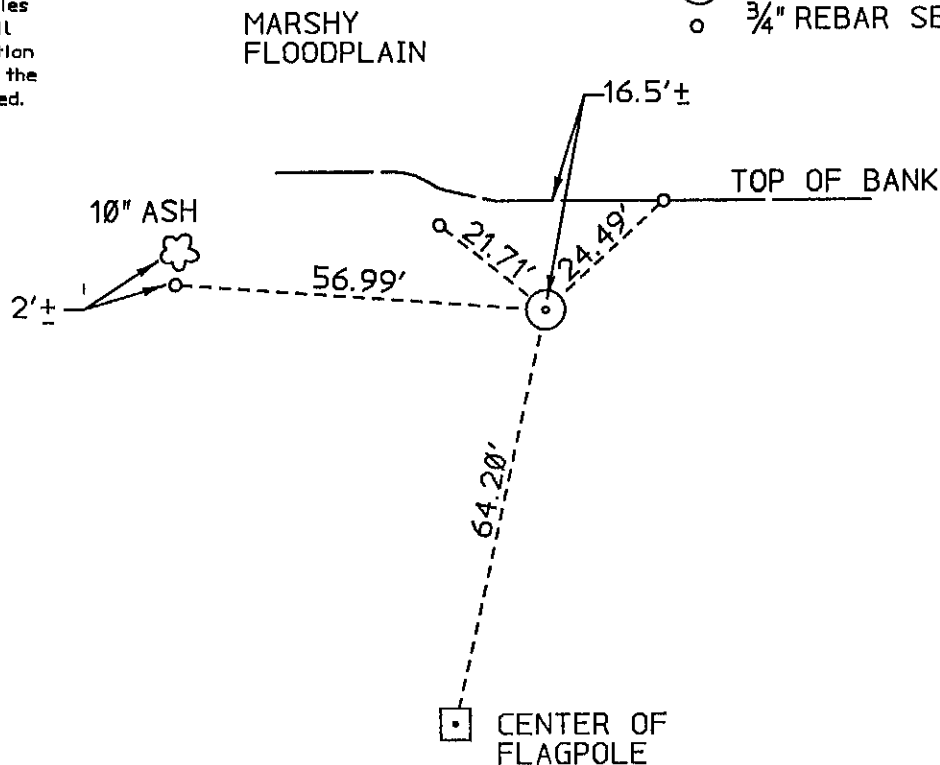

MOBILE HOME

be any material discrepancy between the location of the corner as restored or reestablished and the location of that corner as previously restored or reestablished by distance and direction. Show the discrepancy in the plan view drawing under (d) and (1) the corner as restored or reestablished, and (2) to at least 2 of the witness monuments shown on the drawing in (d), above.

(c) known discrepancy

(f) Was the corner restored through acceptance of (1) an obliterated evidence location, or, (2) a found perpetuated location?

Obliterated evidence location

(g&h) Was the corner reestablished through lost corner proportionate methods? If so, show the method, including the directions and distances to other public land survey corners used as evidence or used for proportioning in determining the corner location?

Not a lost corner

Affix Land Surveyor Seal

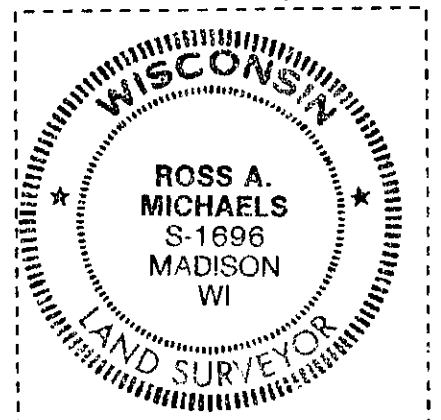

(i) I, Ross A. Michaels

(type or print name) certify that the corner location shown on this record was determined by me or under my direction and control and that this U.S. Public Land Survey Monument Record is correct and complete to the best of my knowledge and belief.

Ross A. Michaels  
Signature

April 21, 1997  
Date