

AUG 7 1986

GRANT COUNTY U.S. PUBLIC LAND SURVEY MONUMENT RECORD

TYPE OF MONUMENT: 1" X 40" Iron Rod
TIES ARE AS INDICATED ON SKETCH

WITNESSES TO CORNER LOCATION

Sean M. Walsh
Derik L. Tracy

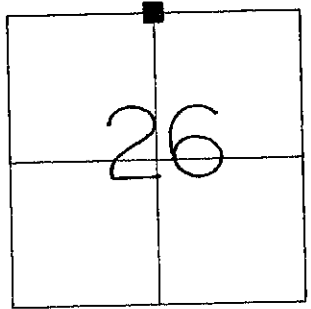

CORNER LOCATION

North 1/4 Corner, Section 26, T 8 N, R 3 W
Town of Boscobel

BASIS FOR MONUMENT LOCATION

Subsequent to Original Gov't. survey, the most recent record of this corner having been re-established is from a 1977 survey by Mr. L. Schmit in conjunction with the subdivision of Section 26 for the City of Boscobel.

After having traversed the Northwest One-quarter of Section 26 and searching the area for evidence of previous monumentation, I re-established and monumented this corner at a location which is in accordance with the information contained on the 1977 survey by Mr. Schmit.

I, hereby certify that this information is correct and true to the best of my information, knowledge and belief.

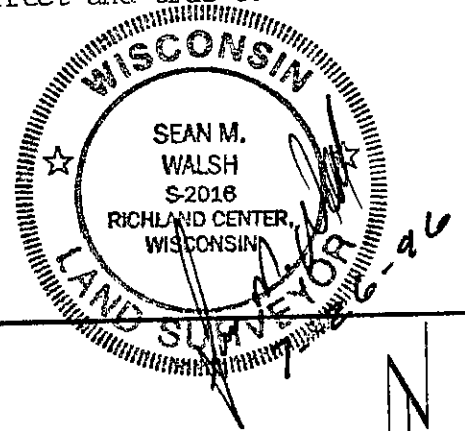

- - 1" X 40" Iron Rod Set at Corner
- - 3/4" X 24" Iron Rod Set as Tie

TIE SKETCH

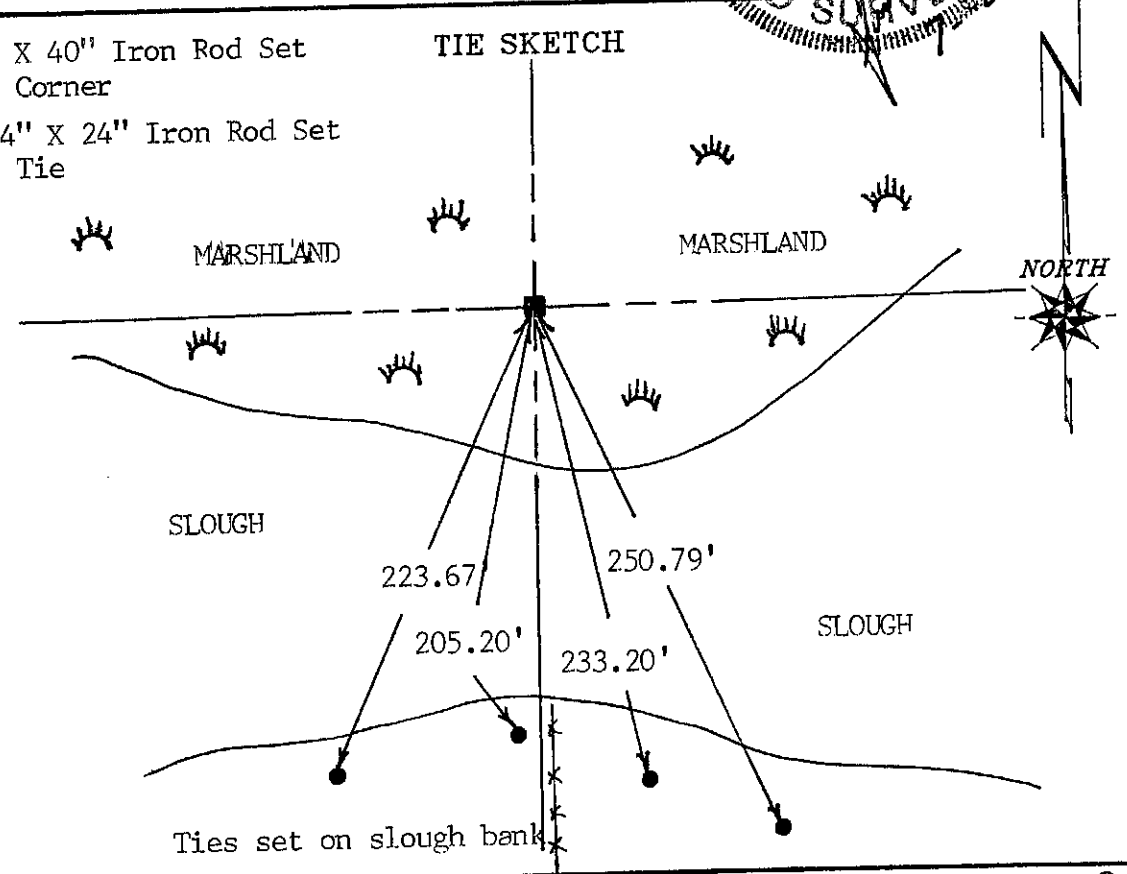

Ties set on slough bank