

REC'D FEB 13 1997

GRANT COUNTY U.S. PUBLIC LAND SURVEY MONUMENT RECORD

TYPE OF MONUMENT: 1" Iron Pipe
TIES ARE AS INDICATED ON SKETCH

WITNESSES TO CORNER LOCATION

Sean M. Walsh
Christopher G. Reedy

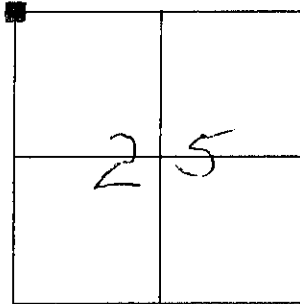

CORNER LOCATION

Northwest Corner
Section 25
Town 8 North, Range 3 West
Boscobel Township

BASIS FOR MONUMENT LOCATION

1977 a 1" Iron pipe was set at this location by Mr. L. Schmitt in conjunction with a survey for the City of Boscobel. The 1" iron pipe was used subsequently by D. Davis.

I found a City of Boscobel Aluminum monument 11.42' Southwest of the 1" iron pipe at a fence corner.

I accepted the Iron pipe as the corner which fits best with the section dimensions to the South and perpetuated as shown hereon.

This information is correct and true to the best of my knowledge and belief.

- - 1" Iron Pipe Monument Found at Corner
- - 3/4" X 24" Iron Rod Set as Tie

Tie distances were taped horizontally.

TIE SKETCH

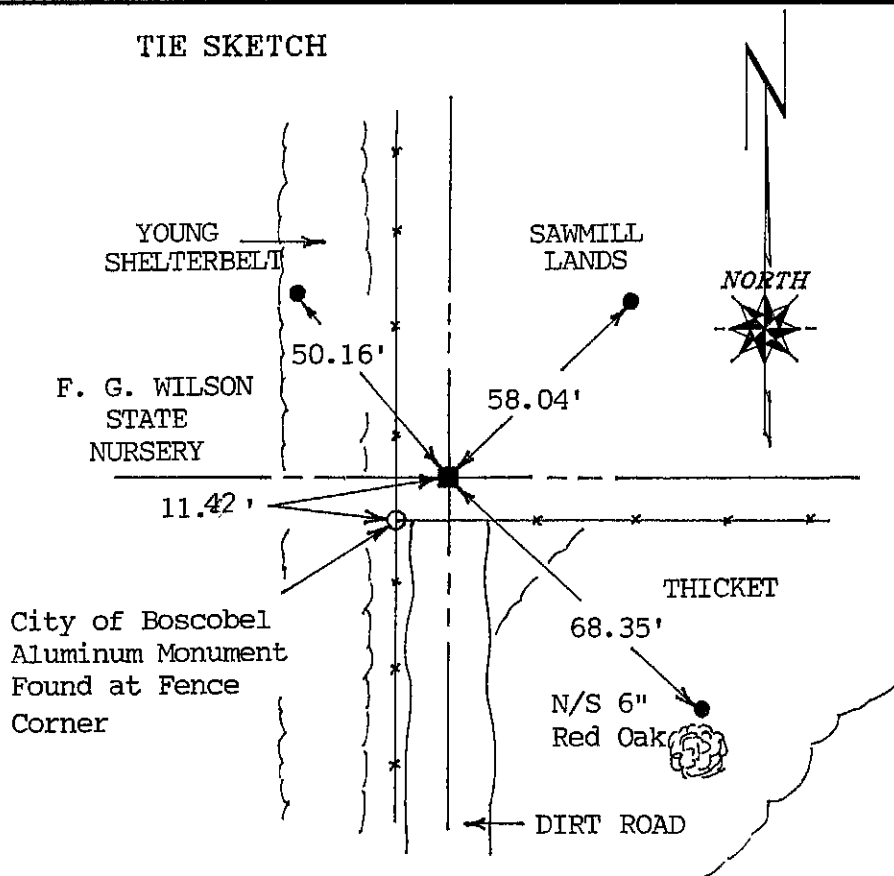

Sean M. Walsh
1-24-97