

U. S. PUBLIC LAND SURVEY MONUMENT RECORD

GRANT County, Wisconsin.

2

Basis for monument location.

Located a 3/4" diameter reinforcing bar at the occupied fence corner. Only available evidence of the corner was the reinforcing bar. Accepted bar as true corner.



SEP 9 1985

Section 19, T 8 N, R 1 W

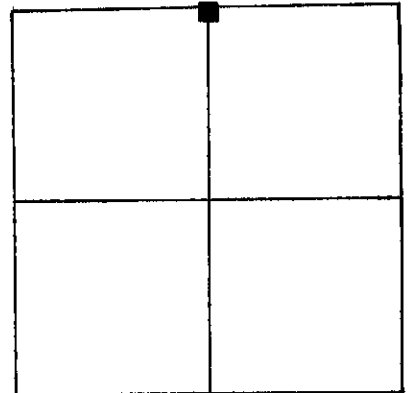

Corner Location (Indicate by ■)



Tie sketch

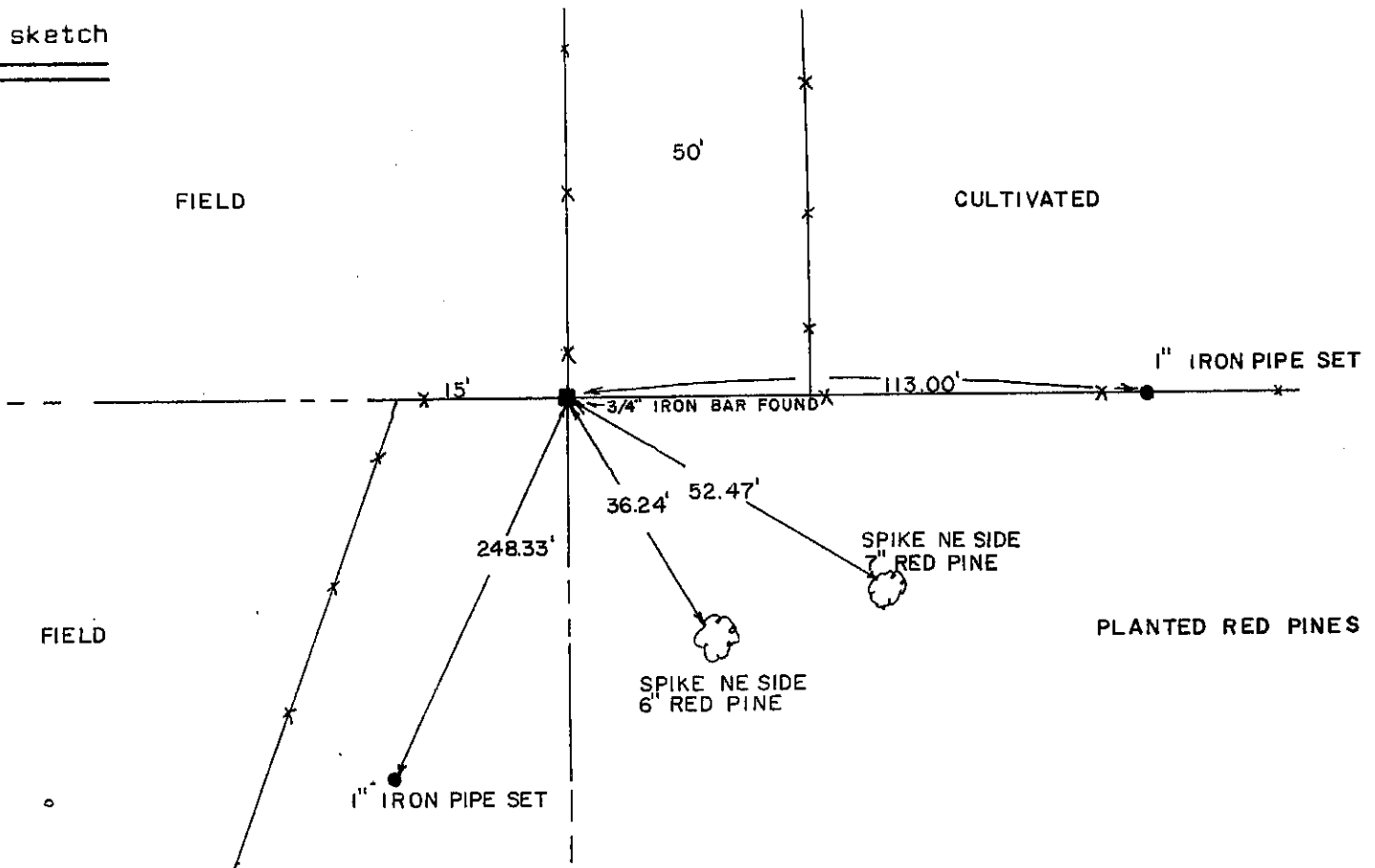

I, MATTHEW J. JAVIAK Certify that the corner location shown hereon this record was determined by me or under my direction and control and that this U. S. Public Land Survey Monument Record is correct and complete to the best of my knowledge and belief.

9-5-85
Date

Matthew J. Javjak
Registered Land Surveyor



#164

WELSH CONT'D

NORTH 1/4 CORNER
SECTION 19 T8N R1W
3/4" IRON ROD FOUND

(5)

