

COPY

WATERSTOWN

GOVERNMENT CORNER RECORD APR 25 1995

SOUTHWEST CORNER, SECTION 16, TOWNSHIP 8 NORTH, RANGE 2 EAST, WEST,

TOWN, CITY OR VILLAGE OF WATERSTOWN

TYPE OF MONUMENT: 3/4" IRON ROD ELEVATION - M.S.L. DATUM

WITNESSES TO CORNER LOCATION

Christopher G. Reedy

Curtis J. Cumber

SECTION 16, T 8, N, R 2, EW

TOWN OF WATERSTOWN

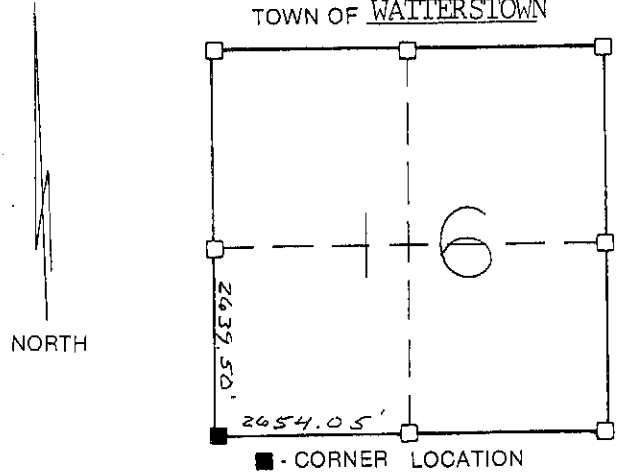

TIE SKETCH (SHOW ALL HELPFUL FEATURES)

COPY

All ties are 60d Pole Spikes set in Blazes as indicated.

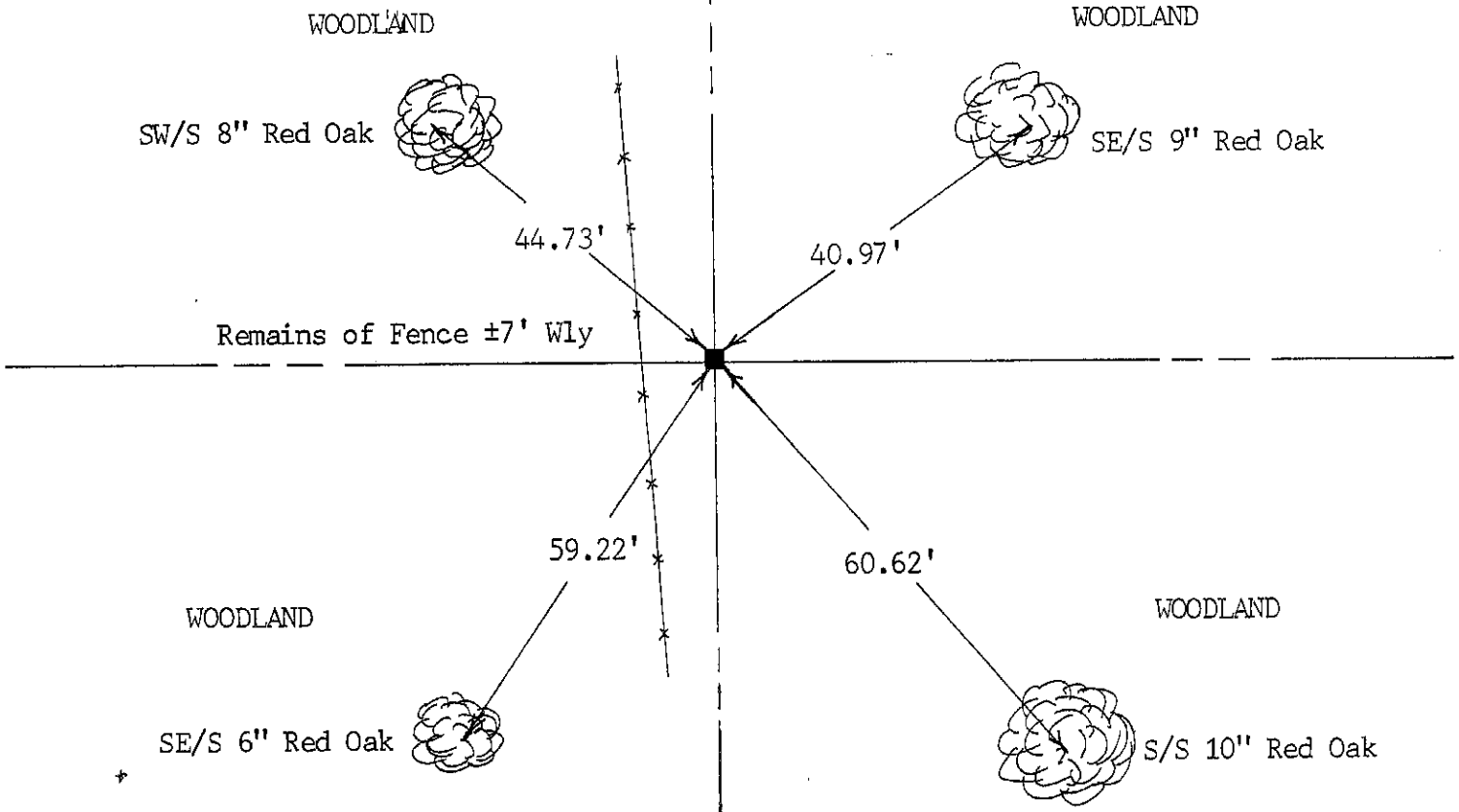

SURVEYOR'S CERTIFICATE

SEAL S. 2016

I, Sean M. Walsh, DO HEREBY CERTIFY THAT I have re-established this corner at a location where the projected occupied West and South lines of the Section intersect. The existing fence in the vicinity of the corner is not straight and not a good indication of occupation. There is no other acceptable evidence in the area. This information is correct to the best of my knowledge, information and belief.

DATED THIS 17 DAY OF APRIL, 19 95

REGISTERED LAND SURVEYOR

