

COPY

APR 25 1995

GOVERNMENT CORNER RECORD

SOUTH EAST CORNER, SECTION 16, TOWNSHIP 8 NORTH, RANGE 2 EAST - WEST,

TOWN, CITY OR VILLAGE OF WATTERSTOWN

TYPE OF MONUMENT: 3/4" IRON ROD ELEVATION - M.S.L. DATUM

WITNESSES TO CORNER LOCATION

Christopher G. Reedy

Curtis J. Cummer

SECTION 16, T 8 N, R 2 EW

TOWN OF WATTERSTOWN

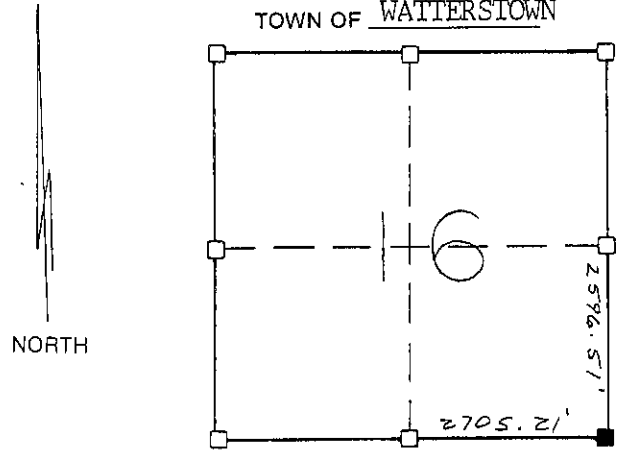

■ - CORNER LOCATION

All ties are 60d Pole Spikes set as indicated.

TIE SKETCH (SHOW ALL HELPFUL FEATURES)

WOODLAND

NE/S 19" Red Oak



38.18'

54.47'

WOODLAND

NW/S 14" Black Oak



NW/S 25" Red Oak

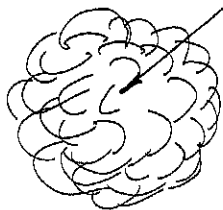

31.40'

45.01'

SW/S 9" White Oak



WOODLAND

WOODLAND

SURVEYOR'S CERTIFICATE

SEAL S. 2016

I, Sean M. Walsh, DO HEREBY CERTIFY THAT I have re-established this corner at a location which was determined by physical occupation as the only acceptable evidence. After traversing through and locating the corners along the South and East lines of Section 16, I determined that the physical occupation provides the best location. This information is correct and true to the best of my knowledge and belief.

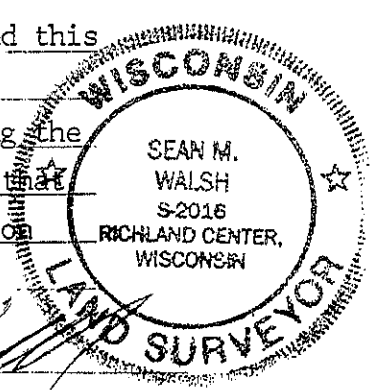

DATED THIS 17 DAY OF April, 19 95

REGISTERED LAND SURVEYOR