

Survey Monument Record

TYPE OF MONUMENT 3/4" x 24" IRON BAR SET

CORNER NO. 117
 SECTION 34
 TOWN 7N
 RANGE 3W

FIELD BOOK: 96-12
 PAGE (4)

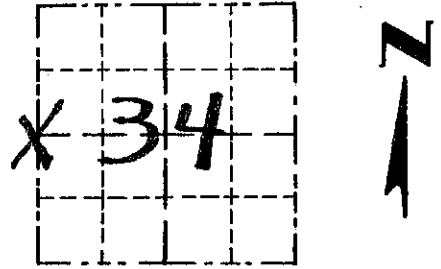

BASIS FOR MONUMENT LOCATION

(Use reverse side if necessary)

Show info such as: History of corner, with reference to Vol. and pg., dates, surveyor; exact description of monument replaced; if location computed, by taped or EDM traverse; landowner, remarks, etc.

SEAL:

CORNER SET IN 1833 BY HARVEY CLARKE. ORIGINAL BEARING TREES WERE UNRECOVERABLE. NO RECORD OF CORNER FOUND SINCE ORIGINAL SURVEYS. CORNER SET IN FENCE NORTH / SOUTH AND MIDWAY BETWEEN NW COR AND OCCUPATION 1/2 MILE SOUTH. VERIFIED ITS LOCATION BY EDM TRAVERSE OF AREA

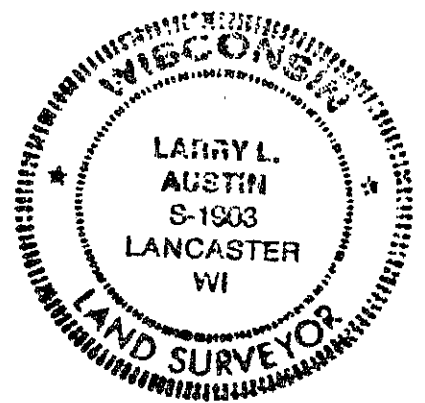

CERTIFIED CORRECT
Larry L. Austin
 Registered Land Surveyor
 DATE: 8/22/96

TIE SKETCH

Show at least three (3) ties and monument

- LEGEND
- ⊕ 3/4" x 24" IRON BAR SET
 - 1/2" x 18" IRON BAR SET
 - XX EXISTING FENCE

