

REC'D MAR 31 1997

GRANT COUNTY U.S. PUBLIC LAND SURVEY MONUMENT RECORD

TYPE OF MONUMENT: 3/4" X 24" Iron Rod
TIES ARE AS INDICATED ON SKETCH

WITNESSES TO CORNER LOCATION

Sean M. Walsh

 Christopher G. Reedy

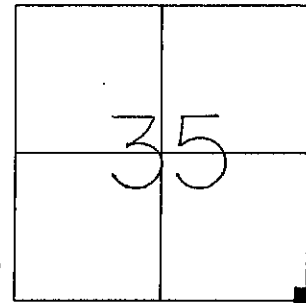
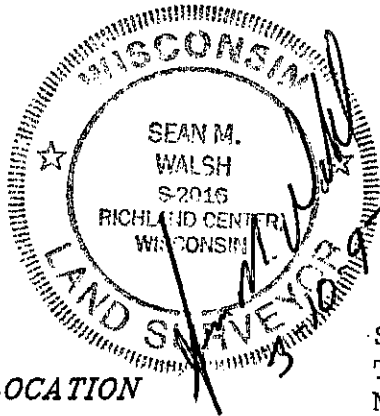

CORNER LOCATION
 Section 35
 Town 7 North, Range 3 West
 Marion Township

BASIS FOR MONUMENT LOCATION

I, Sean M. Walsh, Do hereby Certify:

No evidence of this corner having been used could be located subsequent to the Original Gov't. Survey.

I re-established this corner at a location which is East 21.78 feet from the occupied Northeast corner of Section 2, T8N, R3W, as was specified in the Orig. Gov't. Survey.

This information is correct and true to the best of my knowledge, information and belief.

TIE SKETCH

■ - 3/4" X 24" Iron Rod Set at Corner

Tie distances were taped horizontally.

Tree ties are a 60d common pole spike set in a blaze at the base of the tree as indicated.

