

W73

FEB 26 1993

# GRANT COUNTY U.S. PUBLIC LAND SURVEY MONUMENT RECORD

TYPE OF MONUMENT: 3/4" X 24" Iron Rod  
TIES ARE AS INDICATED ON SKETCH

WITNESSES TO CORNER LOCATION

Sean M. Walsh  
Christopher G. Reedy

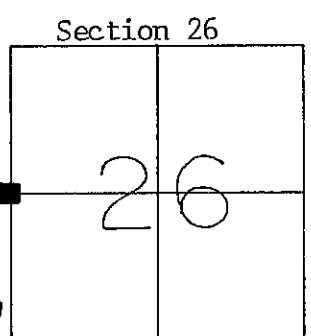
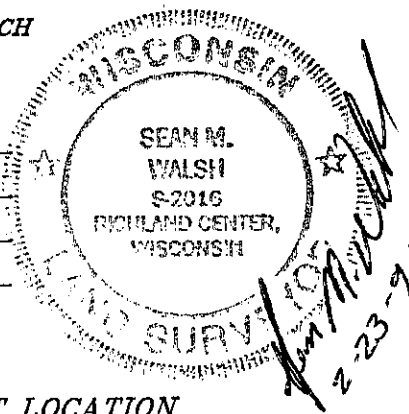

CORNER LOCATION  
T7N, R3W  
Town Of Marion

### BASIS FOR MONUMENT LOCATION

I, Sean M. Walsh, Registered Land Surveyor, do hereby certify that I have re-established this corner in accordance with the information contained hereon and that this information is correct and true to the best of my information, knowledge and belief.

No acceptable evidence exists indicating the position for this corner, thus I have re-established said corner at the location where a straight line between the Northwest and Southwest Corners of the Section intersect the line of physical occupation running East and West.

● - 3/4" X 24" Iron Rod Set and Buried ±12" as Tie  
Tie distances measured horizontally by EDM.

### TIE SKETCH

