

REC'D

W90

FEB 26 1996

GRANT COUNTY U.S. PUBLIC LAND SURVEY MONUMENT RECORD

TYPE OF MONUMENT: 3/4" X 24" Iron Rod
TIES ARE AS INDICATED ON SKETCH

WITNESSES TO CORNER LOCATION

Sean M. Walsh

Christopher G. Reedy

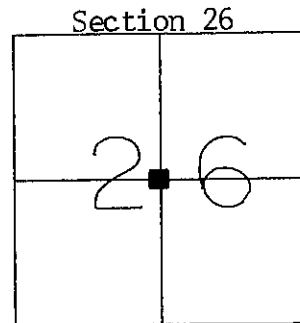
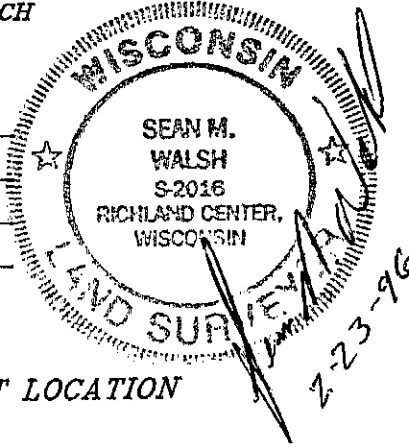

CORNER LOCATION
T7N, R3W
Town of Marion

BASIS FOR MONUMENT LOCATION

I, Sean M. Walsh, Registered Land Surveyor, do hereby certify that I have established the corner shown hereon at a location which was determined by intersecting straight lines between quarter corners.

This information is correct and true to the best of my knowledge, information and belief.

No other acceptable evidence could be located which would indicate any different location for this corner.

● - 3/4" X 24" Iron Rod Set as Tie

Tree ties are 60d pole spikes set in blazes as indicated.

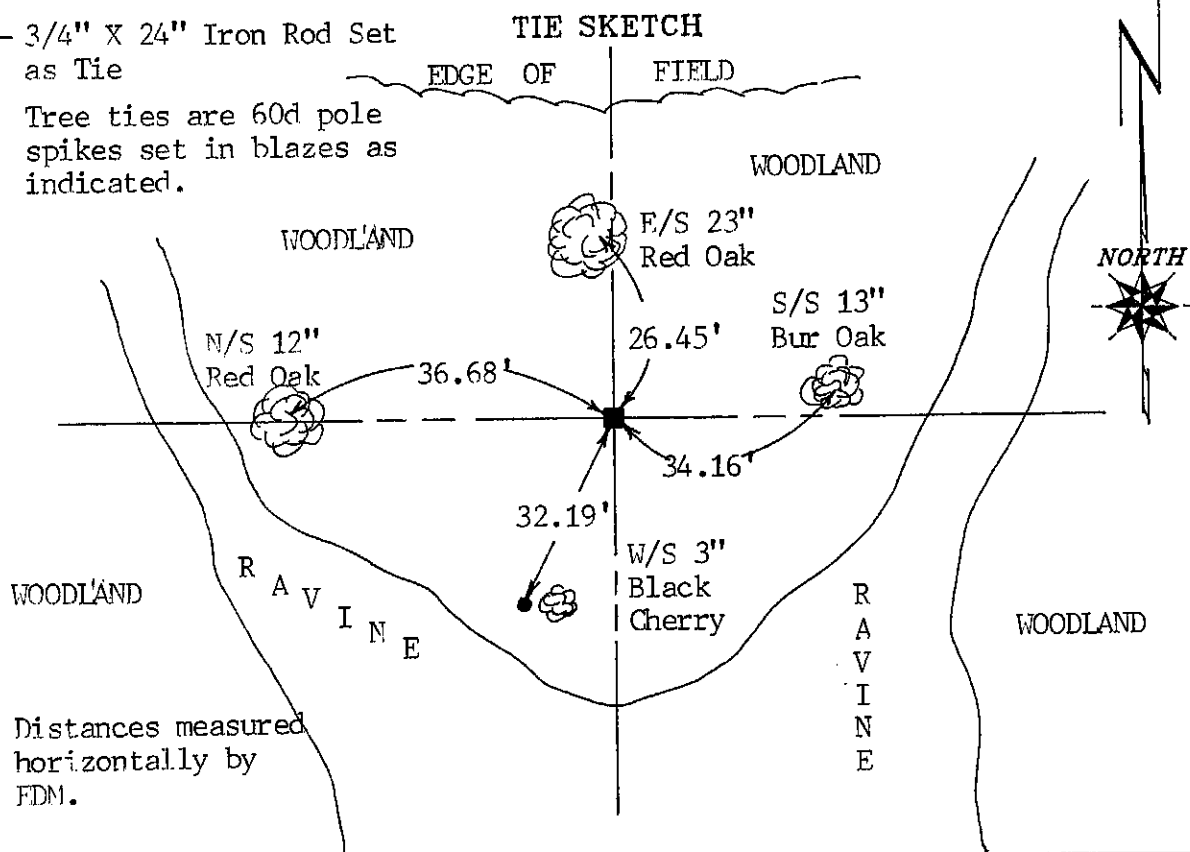

Distances measured horizontally by EDM.