

W72

FEB 26 1996

GRANT COUNTY U.S. PUBLIC LAND SURVEY MONUMENT RECORD

TYPE OF MONUMENT: 3/4" X 24" Iron Rod
TIES ARE AS INDICATED ON SKETCH

WITNESSES TO CORNER LOCATION

Sean M. Walsh

Christopher G. Reedy

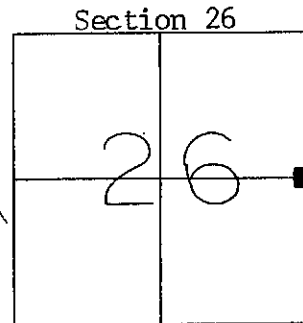
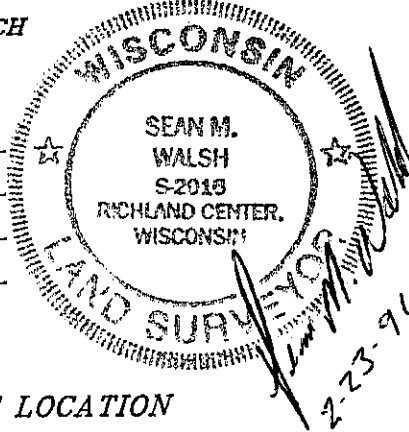

CORNER LOCATION
T7N, R3W
Town of Marion

BASIS FOR MONUMENT LOCATION

Subsequent to Original Gov't. Survey, no acceptable record evidence could be located.

I re-established this corner at the mid-point of a straight line between the Northeast and Southeast corners of Section 26.

I do hereby certify that this information is correct and true to the best of my information, knowledge and belief.

●-3/4" X 24" Iron Rod Set as Tie

TIE SKETCH

