

REC'D AUG 24 1994

GOVERNMENT CORNER RECORD

South 1/4 CORNER, SECTION 10, TOWNSHIP 7 NORTH, RANGE 3 ~~WEST~~ WEST,

TOWN, CITY OR VILLAGE OF Marion

TYPE OF MONUMENT: Drive Shaft Found ELEVATION - M.S.L. DATUM _____

WITNESSES TO CORNER LOCATION

Sean M. Walsh

Ryan Keegan

SECTION 10, T. 7 N, R. 3 ~~EW~~ EW

TOWN OF Marion

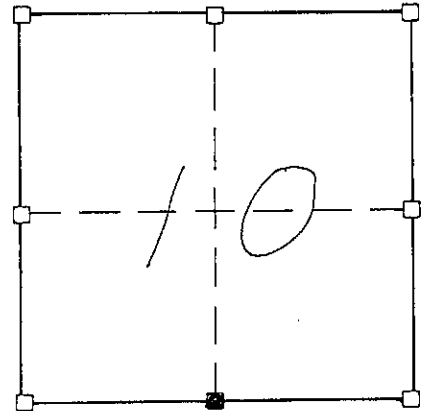

NORTH

TIE SKETCH
(SHOW ALL HELPFUL FEATURES)

Hickory



Ties in trees are 60 penny polespikes set in blaze at base of tree as noted.

WOODED

35.49'

3/4" x 24" Iron rod set

15.67'

THICKET

WOODED

60.38'

27.22'

THICKET

3/4" x 24" iron rod set



NW/S 13" Hickory

SURVEYOR'S CERTIFICATE

SEAL S- 2016

I, Sean M. Walsh, DO HEREBY CERTIFY THAT I have accepted and perpetuated
the above corner location as the best available evidence. I located
a drive shaft at this location and perpetuated as shown above.
This information is correct and true to the best of my
information, knowledge and belief.

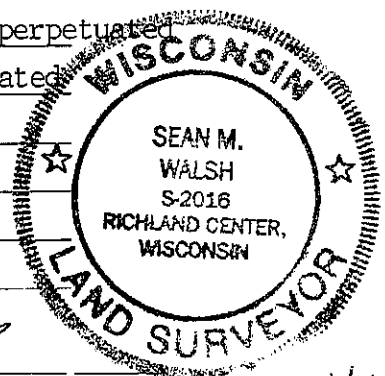

DATED THIS 4 DAY OF AUG, 19 94

REGISTERED LAND SURVEYOR

46