

REC'D JUN 4 1997

GRANT COUNTY U.S. PUBLIC LAND SURVEY MONUMENT RECORD

TYPE OF MONUMENT:

TIES ARE AS INDICATED ON SKETCH

WITNESSES TO CORNER LOCATION

Sean M. Walsh

Christopher G. Reedy

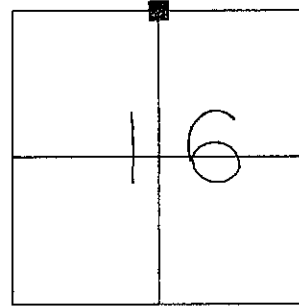

CORNER LOCATION
North 1/4 Corner
Section 16
Town 7 North, Range 3 West
Marion Township

BASIS FOR MONUMENT LOCATION

Subsequent to Original Gov't. Survey, this corner was used in 1874 by Geo. McFall at which time he documented having placed a stone monument. I could not locate any evidence of this or any other previous survey. the surrounding area appears to have been cleared by some excavation activity in the past.

I re-established this corner at a location which is at the Mid-point of a straight line between the Northeast and Northwest corners of Section 16.

I do hereby certify that this information is correct and true to the best of my information, knowledge and belief.

TIE SKETCH

■ - 3/4" X 24" Iron Rod
Placed at Corner

● - 3/4" X 24" Iron Rod
Set as Tie

Tree ties are a 60d common pole spike set in a blaze at the base of the tree as indicated.

Tie distances were measured horizontally by E.D.M.

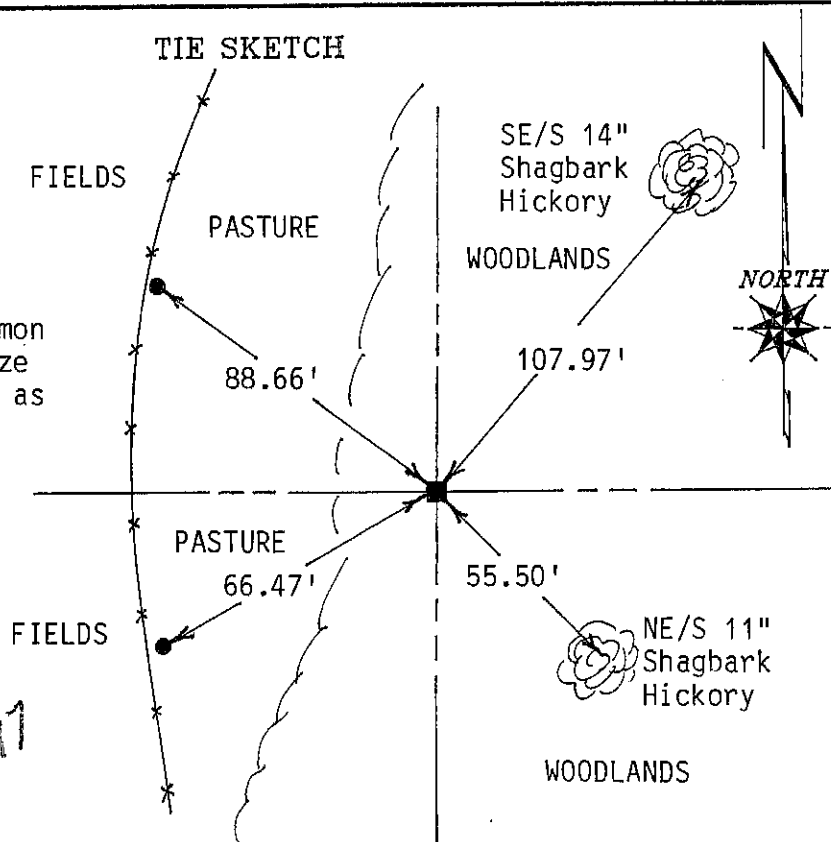

Handwritten signature and date:
4-30-97