

GRANT COUNTY CERTIFIED LAND CORNER

CORNER NO. 36

CERTIFICATE:

I, LARRY L. AUSTIN, DO HEREBY CERTIFY THAT ON 12 DAY OF NOVEMBER, 1998, I FOUND OCCUPATIONAL EVIDENCE OF THE WEST 1/4 CORNER OF SECTION 9, TOWN 7 NORTH, RANGE 3 WEST OF THE FOURTH PRINCIPAL MERIDIAN, AND I RE-ESTABLISHED SAID CORNER ACCORDING TO THE WISCONSIN STATUTES AS SHOWN AND DESCRIBED HEREON.

DATED THIS 30th DAY OF June, 1998

Larry L. Austin
LARRY L. AUSTIN S-1903

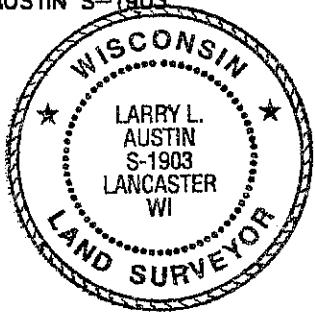

SEAL

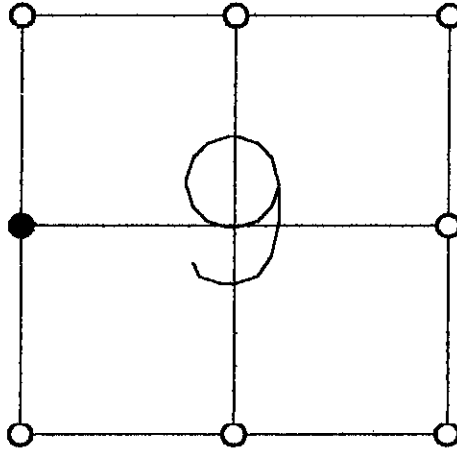

● = CORNER LOCATION
WEST 1/4 OF SECTION 9
T 7 N R 3 W
TOWN OF MARION

HISTORY OF ORIGINAL CORNER ESTABLISHMENT:

CORNER SET IN 1833 BY HARVEY PARKE.
NO OTHER RECORD OF CORNER FOUND.

DESCRIPTION OF CORNER EVIDENCE FOUND:

I FOUND AN OCCUPIED NORTH/SOUTH FENCE WITH A DOUBLE BRACE. I WENT NORTH AND SOUTH OF THIS LOCATION AND IT FIT WELL WITH THE OTHER CORNERS IN THE AREA. VERIFIED THIS LOCATION USING E.D.M. AND G.P.S. METHODS.

DESCRIPTION OF CORNER AND WITNESS MONUMENTS, REFERENCES AND ACCESSORIES USED TO PERPETUATE THE ORIGINAL OR RE-ESTABLISHED LOCATION OF THIS CORNER:

WITNESS TO THE CORNER LOCATION:

BOBBY SEDGWICK
SHELBY BLINDERT

SKETCH:

