

# GRANT COUNTY

## Survey Monument Record

TYPE OF MONUMENT 3/4" IRON BAR FND.

STATE PLANE COORDINATES: N \_\_\_\_\_  
E \_\_\_\_\_

ELEVATION — M.S.L. DATUM: \_\_\_\_\_

THETA ANGLE: \_\_\_\_\_

FIELD BOOK: 96-14

PAGE (7)

CORNER NO. 3

SECTION 1

TOWN 6N

RANGE 2W

### BASIS FOR MONUMENT LOCATION

(Use reverse side if necessary)

CORNER SET IN 1832 BY  
SIBLEY. NO RECORD OF CORNER  
FOUND SINCE ORIGINAL SEAL:  
SURVEYS. I FOUND A 3/4"  
IRON ROD AT A FENCE  
INTERSECTION. I ACCEPTED  
IT AFTER EDM TRAVERSE  
OF AREA.

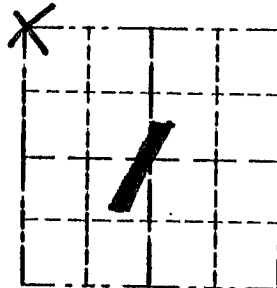

LOCATION  
(Indicated by "X")

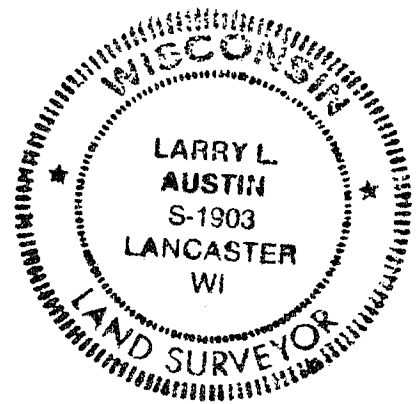

CERTIFIED CORRECT

*Larry L. Austin*  
Registered Land Surveyor

DATE: 9-10-96

### TIE SKETCH

Show at least three (3) ties and monument

#### LEGEND

⊕ 3/4" IRON BAR SET

○ 1/2" x 18" IRON BAR SET

— x — x — EXISTING FENCE

..... POWER LINE 84.41'

