

MAR 28 1995

GOVERNMENT CORNER RECORD

W 1/4 CORNER, SECTION 24, TOWNSHIP 7 NORTH, RANGE 2 EAST - WEST,
 TOWN, CITY OR VILLAGE OF Hickory Grove
 TYPE OF MONUMENT: 1/2" Iron rod located ELEVATION - M.S.L. DATUM _____

WITNESSES TO CORNER LOCATION

Sean M. Walsh
Christopher G. Reedy
Curtis J. Cummer

SECTION 24, T. 7 N, R. 2 EW
 TOWN OF Hickory Grove

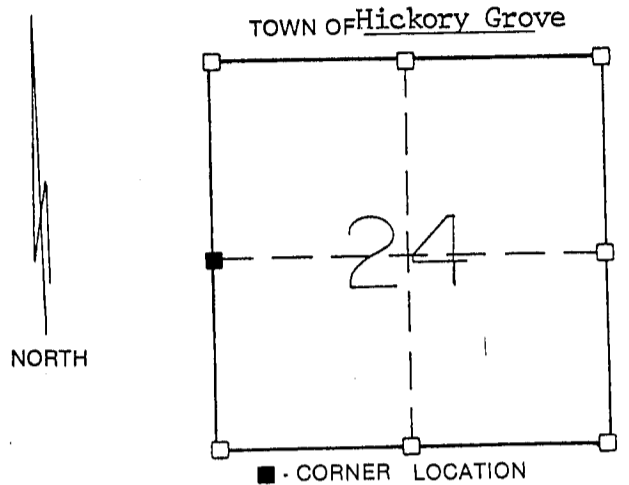

TIE SKETCH
 (SHOW ALL HELPFUL FEATURES)

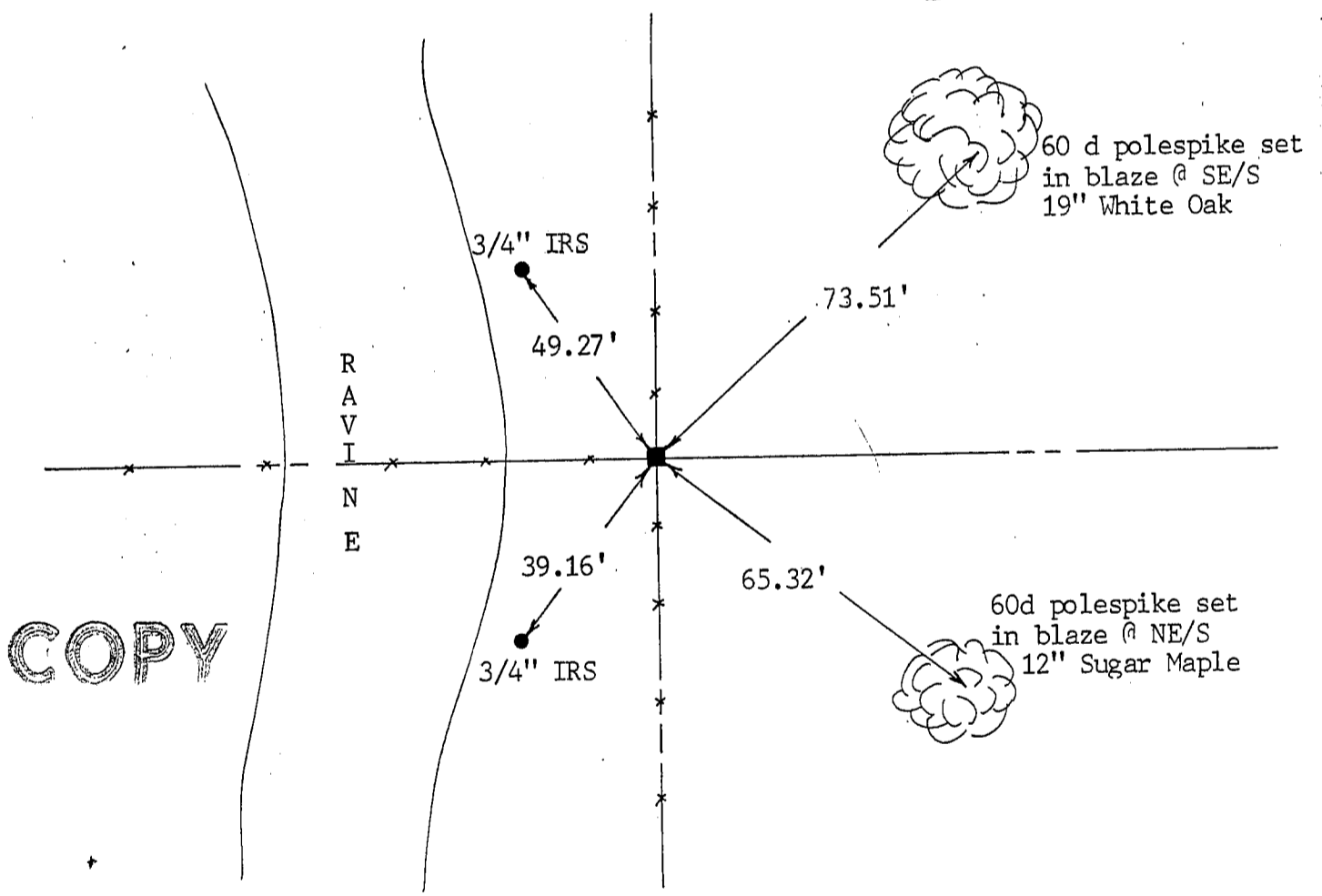

COPY

SURVEYOR'S CERTIFICATE

SEAL S. 2016

I, Sean M. Walsh, DO HEREBY CERTIFY THAT I have accepted and perpetuated
the above corner in accordance with the information contained hereon and
that this information is correct and true to the best of my knowledge
and belief. I located a 1/2" dia. iron rod at this location of
physical occupation and accepted it as the only available evidence.

DATED THIS 15 DAY OF MARCH, 19 95

Sean M. Walsh
 REGISTERED LAND SURVEYOR

