

# GRANT COUNTY

## Survey Monument Record

TYPE OF MONUMENT 3/4" X 24" IRON BAR SET

STATE PLANE COORDINATES: N W/ CAP  
E \_\_\_\_\_

ELEVATION — M.S.L. DATUM: \_\_\_\_\_

THETA ANGLE: \_\_\_\_\_

FIELD BOOK: 95-18

PAGE \_\_\_\_\_

CORNER NO. 83  
SECTION 26  
TOWN 7N  
RANGE 2W

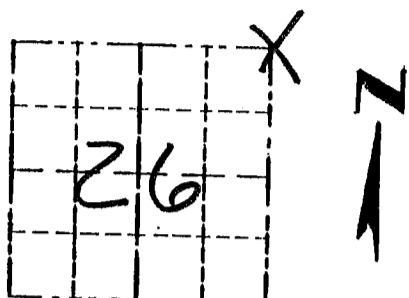

LOCATION  
(Indicated by "X")

### BASIS FOR MONUMENT LOCATION

(Use reverse side if necessary)

CORNER SET IN 1833 BY HARVEY PARKE; NO RECORD FOUND OF CORNER SINCE THAT TIME. A P.K. NAIL FND. AT Proj. FENCE EAST AND PROJ. OF CENTERLINE NORTH. I REPLACED IT WITH 3/4" X 24" IRON BAR WITH CAP. VERIFIED ITS LOCATION USING EDM METHODS.

SEAL:

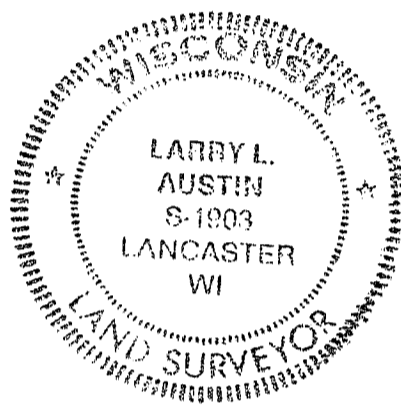

CERTIFIED CORRECT

Larry L. Austin  
Registered / Land Surveyor

DATE: 6-10-96

### TIE SKETCH

Show at least three (3) ties and monument

#### LEGEND

⊕ 3/4" X 24" IRON BAR SET WITH GRANT Co. ALUM. CAP

○ 1/2" X 18" IRON BAR SET

xx EXISTING FENCE

N 52° 08' 36" W - 37.87'

N 39° 36' 16" E - 43.01'

S 26° 16' 30" W - 46.82'

S 33° 02' 11" E - 47.51'

