

MAR 28 1995

GOVERNMENT CORNER RECORD

CENTER 1/4 CORNER, SECTION 13, TOWNSHIP 7 NORTH, RANGE 2 EAST-WEST,

TOWN, CITY OR VILLAGE OF HICKORY GROVE

TYPE OF MONUMENT: 3/4" X 24" IRON ROD

ELEVATION - M.S.L. DATUM _____

WITNESSES TO CORNER LOCATION

Sean M. Walsh

Christopher G. Reedy

SECTION 13, T 7 N, R. 2 EW

TOWN OF HICKORY GROVE

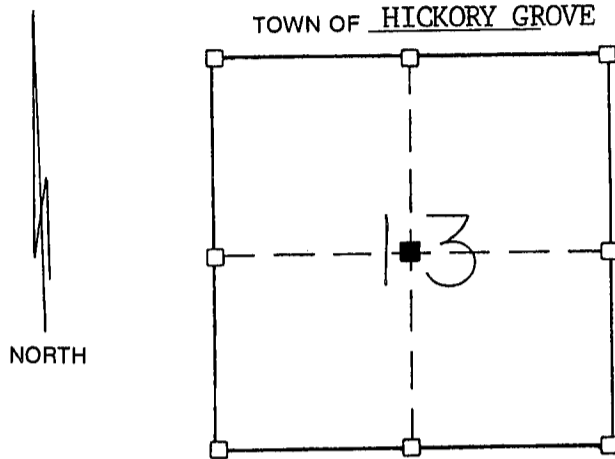

■ - CORNER LOCATION

All tree ties are 60d pole spikes set in blazes as indicated.

TIE SKETCH
(SHOW ALL HELPFUL FEATURES)

WOODLAND

FIELD

NE/S 13" White Oak

SE/S 14" Cherry

WOODLAND

67.74'

76.92'

73.02'

142.35'

NW/S 8" Cherry

3/4" X 24" Iron Rod Set

WOODLAND

WOODLAND

COPY

SURVEYOR'S CERTIFICATE

SEAL S. 2016

I, Sean M. Walsh, DO HEREBY CERTIFY THAT I have established this corner at a point which is at the point of intersection of straight lines between the North & South Quarter corners and the East & West Quarter corners. This information is correct and true to the best of my information, knowledge and belief.

DATED THIS 15 DAY OF MARCH, 19 95

REGISTERED LAND SURVEYOR

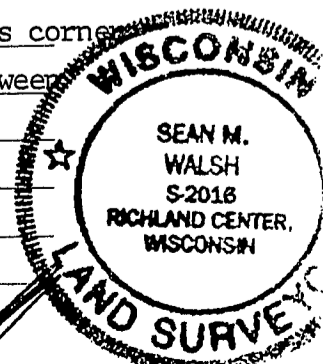

59.5