

JAN 19 1996

GRANT COUNTY

SURVEY MONUMENT RECORD

Center One-quarter corner Section 7, T7N, R2W

SECTION 7, T7N, R2W

TYPE OF MONUMENT: 5/8" DIAMETER IRON ROD LOCATED ON SOUTH SIDE OF LEANING STONE (3" X 8")

TIES ARE 60 PENNY POLESPIKES SET IN BLAZE AT BASE OF TREE AS INDICATED ON SKETCH.

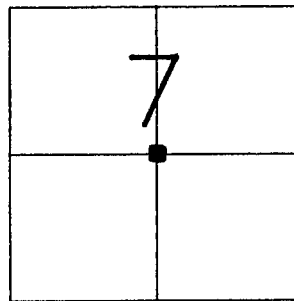

CORNER LOCATION

BASIS FOR MONUMENT LOCATION

I, SEAN M. WALSH, REGISTERED LAND SURVEYOR, DO HEREBY CERTIFY THAT THE INFORMATION CONTAINED HEREON IS, TO THE BEST OF MY KNOWLEDGE, CORRECT AND TRUE.

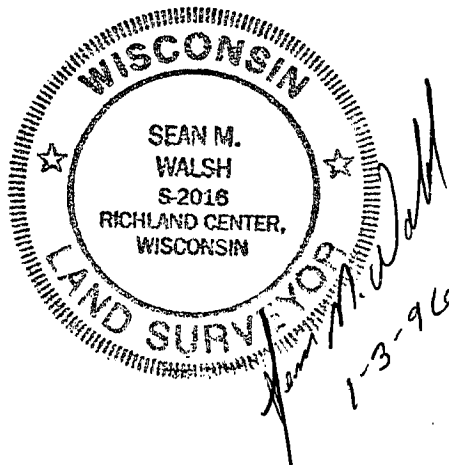

I HAVE ACCEPTED AND PERPETUATED THIS CORNER AS PREVIOUSLY MONUMENTED BY L. E. SCHMIT, DATED 10-20-93, AND BY HERBERT J. GOOLD, DATED APRIL 22, 1889. DOCUMENTATION OF THIS CORNER LOCATION BY GOOLD DOES NOT MAKE MENTION OF STONE MONUMENT, HOWEVER IRON ROD FITS WELL WITH OLD B.T. REMAINS.

