

OCT 15 1991

GOVERNMENT CORNER RECORD

N 1/4 CORNER, SECTION 8, TOWNSHIP 7 NORTH, RANGE 2 ~~EAST~~ - WEST,
 TOWN, CITY OR VILLAGE OF HICKORY GROVE, GRANT COUNTY
 TYPE OF MONUMENT: 3/4" x 24" IRON ROD ELEVATION - M.S.L. DATUM _____

WITNESSES TO CORNER LOCATION

SEAN WALSH

GARY POLLOCK

SECTION 8, T 7 N, R 2 EW

TOWN OF HICKORY GROVE

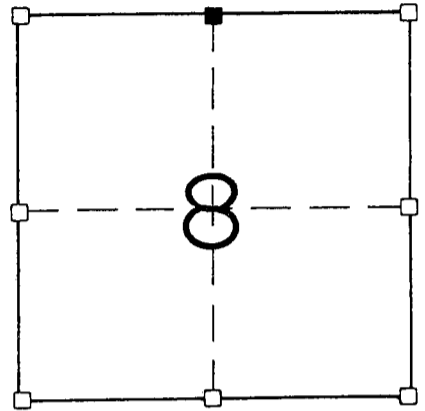

NORTH

TIE SKETCH
(SHOW ALL HELPFUL FEATURES)

3/4" x 24" IRON ROD

SLEEPY HOLLOW TRAIL

80.38'

20d POLESPIKE
SE./S 12" CHERRY

12.95'

WOODED

WOODED

HILLSIDE

20d POLESPIKE
NW./S 11" HICKORY

17.25'

HILLSIDE

20d POLESPIKE
S./S 9" HORNBEAM

3.69'

SURVEYOR'S CERTIFICATE

SEAL S- 2016

I, Sean M. Walsh, DO HEREBY CERTIFY THAT I have established the
 above corner at the location shown hereon and that this
 information is correct and true to the best of my information,
 knowledge and belief. This corner was placed at a location
 determined by the single proportionate method as there
 was no other acceptable evidence, this location fell in

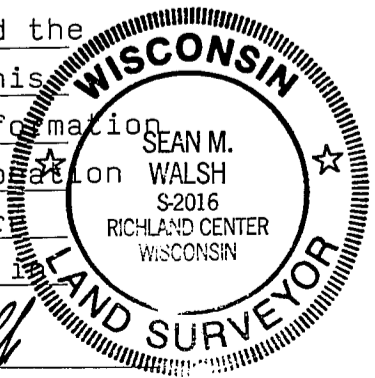

the down remains of an old north/south fence
 DATED THIS 23RD DAY OF SEPTEMBER, 1991

Sean M. Walsh
 REGISTERED LAND SURVEYOR