

CERTIFIED LAND CORNER

STATE OF WISCONSIN)
 COUNTY OF GRANT) S.S.

CERTIFICATE

I, Ronald R. Hayden, do hereby certify that on the 8th day of December 1987, I found (evidence) ~~(no evidence)~~ of the W 1/4 corner of Section 26, T 6 N, R 5 W, Fourth Principal Meridian, and I re-established said corner according to the Wisconsin Statutes as shown and described hereon.

Dated this 21 day of December 19 87

Ronald R. Hayden

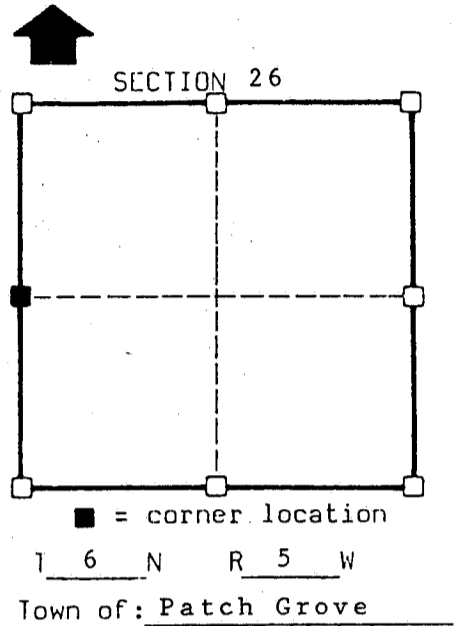
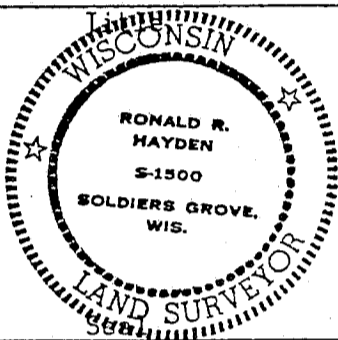

History of original corner establishment:

Town lines established by Lucious Lyon.
 Subdivision by Harvey Parke in 1833.

Description of corner evidence found:

See back.

Description of corner and witness monuments, references and accessories used to perpetuate the original or re-established location of this corner:

Witnesses to corner location:

Ronald R. Hayden
Carol S. Hayden

See back for witness descriptions.

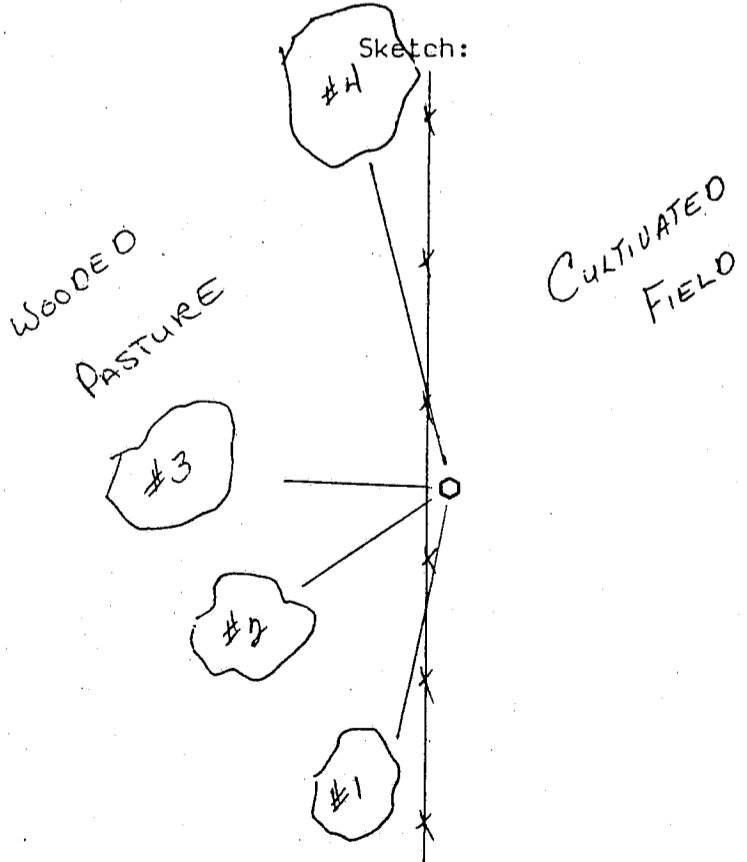

SURVEY CONTROL ORDER

Horizontal
 Vertical

WISCONSIN COORDINATE SYSTEM

Corner	East(X)	North(Y)	Elevation(Z)	Zone
Control Sta. Name				

CORNER EVIDENCE FOUND

I found no physical evidence of a corner, but occupational evidence does exist. After running an extensive control traverse and finding existing corner evidence in Sections 25, 26, 27, 34, 35, and 36, I determined the corner location. Set was a 3/4" X 30" round iron bar with a metal fence post driven east of the corner.

WITNESS DESCRIPTIONS

- 1) Spike nail driven in the east side of a 2.0' diameter red oak which bears: S 10° W 41.63'.
- 2) Spike nail driven in the east side of a 1.4' diameter white oak which bears: S 21° W 34.94'.
- 3) Spike nail set in the South side of a 1.2' diameter red oak which bears: S 88° W 39.15'.
- 4) Spike nail set in the southeast side of a 2.0' diameter white oak which bears: N 12° W 71.29'.