

GRANT COUNTY

Survey Monument Record

TYPE OF MONUMENT 3/4" X 24" IRON ROD SET

STATE PLANE COORDINATES: N _____
E _____

ELEVATION — M.S.L. DATUM: _____

THETA ANGLE: _____

FIELD BOOK: 95-03

PAGE (19)

CORNER NO. 117
SECTION 33
TOWN 6N
RANGE 4W
E 1/4 COR.

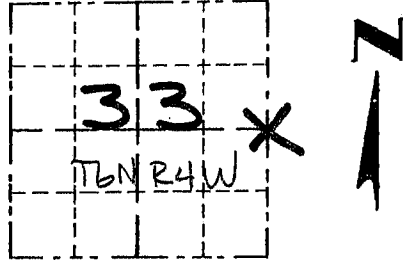

LOCATION
(Indicated by "X")

BASIS FOR MONUMENT LOCATION

(Use reverse side if necessary)

Show info such as: History of corner, with reference to Vol. and pg., dates, surveyor; exact description of monument replaced; if location computed, by taped or EDM traverse; landowner, remarks, etc.

SEAL:

ORIGINAL CORNER SET
IN 1833 BY HARVEY
PARKE

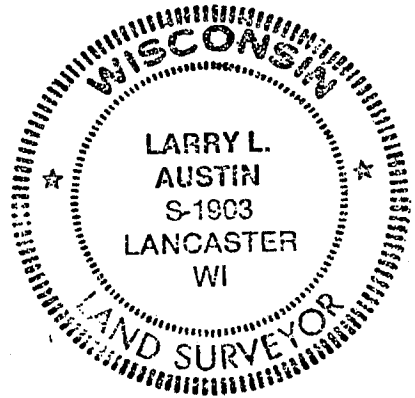

CORNER WAS RESET ON-
LINE AND MIDWAY BETWEEN
THE NORTHEAST CORNER AND
THE SOUTH EAST CORNER OF
SECTION, AND VERIFIED BY
EDM TRAVERSE OF THE AREA

CERTIFIED CORRECT

Larry L. Austin
Registered Land Surveyor

DATE: 7/15/95

TIE SKETCH

Show at least three (3) ties and monument

