

GRANT COUNTY

Survey Monument Record

TYPE OF MONUMENT ALUM. MON. PLACED
 STATE PLANE COORDINATES: N _____
 E _____
 ELEVATION — M.S.L. DATUM: _____
 THETA ANGLE: _____
 FIELD BOOK: 94-15
 PAGE _____

CORNER NO. 130
 SECTION 32
 TOWN 6 N
 RANGE 3 W
S 1/4 COR

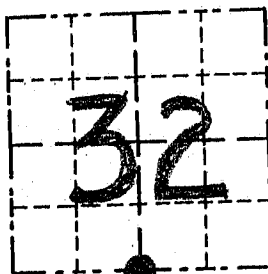

LOCATION
 (Indicated by "•")



BASIS FOR MONUMENT LOCATION

(Use reverse side if necessary)

Show info such as: History of corner, with reference to Vol. and pg., dates, surveyor; exact description of monument replaced; if location computed, by taped or EDM traverse; landowner, remarks, etc.

SEAL:

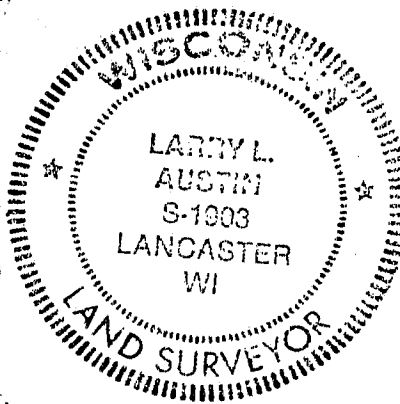

NO RECORD OF CORNER FOUND
SINCE ORIGINAL SURVEYS;
SET THE CORNER AT PROPORTIONED
OF SET FROM OCCUPIED N 1/4
CORNER OF Sec 5 (OFFSET = 20 LKS)
FITS OTHER CORNERS WELL; USED
GPS & EDM METHODS;

CERTIFIED CORRECT

Larry L. Austin
 Registered Land Surveyor

DATE: 9/20/94

TIE SKETCH

Show at least three (3) ties and monument

- LEGEND
- GRANT COUNTY ALUM. MON. PLACED
 - 1" x 24" IRON PIPE PLACED AS TIES
 - ** EXISTING FENCE

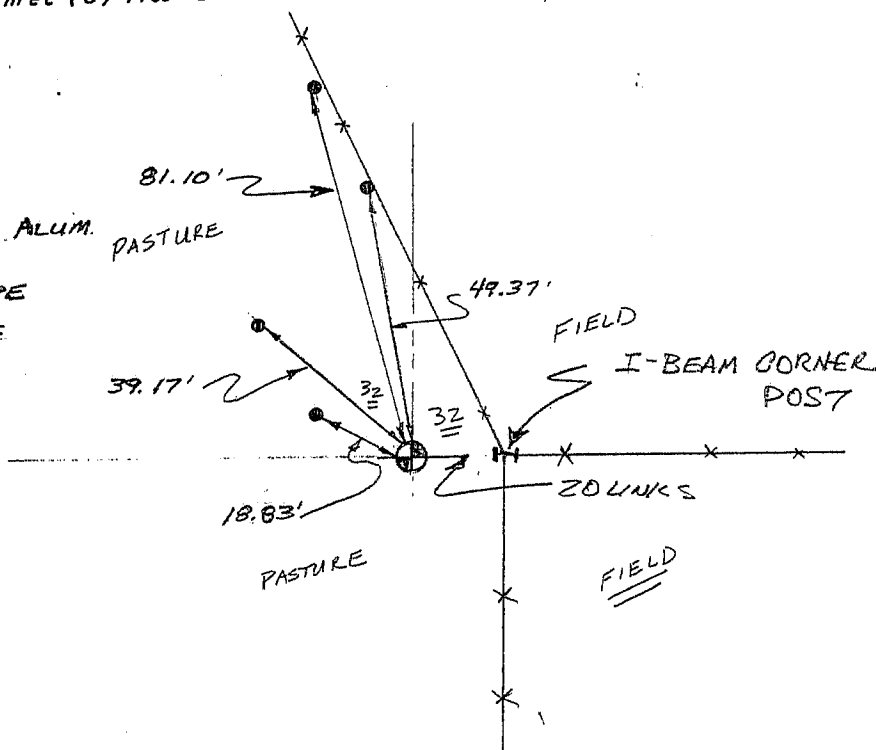

NO SCALE