

FEB 12 1995

GRANT COUNTY

SURVEY MONUMENT RECORD

TYPE OF MONUMENT: 3/4" X 24" Iron Rod
TIES ARE AS INDICATED ON SKETCH

WITNESSES TO CORNER LOCATION

Sean M. Walsh
 Christopher G. Reedy
 John Brown

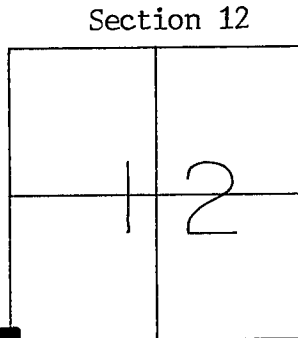
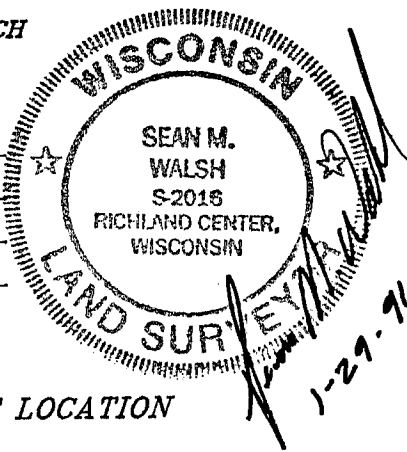

CORNER LOCATION
 T 6 N, R 2 W
 Town of Fennimore

BASIS FOR MONUMENT LOCATION

Subsequent to Original Government Survey, this corner was used in March of 1874 on a survey which subdivided the South 1/2 of Section 11. The 1874 survey placed a stone monument at this corner as well as various forty corners along the East and South lines of Section 11.

Evidence of excavation activity in the area suggests that the record stone was disturbed, and I was unable to locate a stone matching the dimensions described on the 1874 survey.

Upon running the South line of Section 12, I determined that the best available evidence was that of an old corner post in an east/west fence, which fits well with old distances and occupational evidence along said South line.

I have monumented and perpetuated this corner in accordance with the information contained hereon and I hereby certify that this information is correct and true to the best of my information, knowledge and belief.

● - 3/4" X 24" Iron Rod Tie

Tree ties are 60d pole spikes set in blazes as indicated.

Note: The corner is presently marked by a 3/8" X 1/2" deep hole in a 2.5' X 3' sandstone. This surface stone will be moved and the rod monument will be placed following the Spring thaw of 1996.

