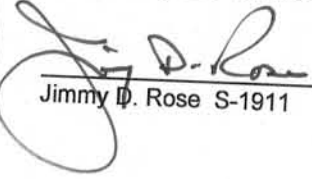

U.S. PUBLIC LAND SURVEY MONUMENT RECORD - GRANT COUNTY, WI
 Section 14 Town 5 North Range 5 West, Town of Patch Grove

CERTIFICATE:

I, Jimmy D. Rose, do hereby certify that the corner location on this record was determined by me and/or under my direct supervision and that this U.S. Public Land Survey Monument Record is correct and complete to the best of my knowledge and belief.

Dated this 6th day of November, 2012

 Jimmy D. Rose S-1911

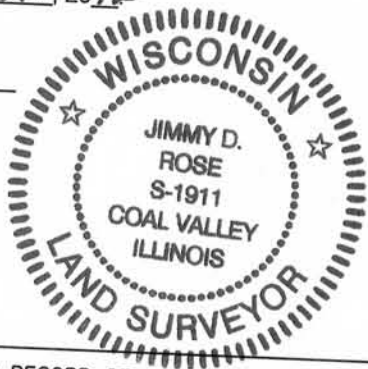

● = CORNER LOCATION

HISTORY OF CORNER ESTABLISHMENT: NO RECORD OF CORNER RE-ESTABLISHMENT SINCE ORIGINAL GOVERNMENT SURVEYS WAS UNCOVERED.

DESCRIPTION OF CORNER EVIDENCE FOUND: ESTABLISHED CORNER BY PROPORONATE METHODS BETWEEN NW AND NE SECTION CORNERS. VERIFIED LOCATION BY TYING TO REMAINING CORNERS IN SECTION 14.

DESCRIPTION OF CORNER AND WITNESS MONUMENTS, references and accessories used to perpetuate the original or re-established location of this corner.

SKETCH:

LEGEND

- ▲ SET 1" DIA. REBAR W/ GRANT COUNTY MONUMENT CAP
- SET 5/8" DIA. REBAR

