



Describe any material discrepancy between the location of the corner as restored or reestablished and the location of that corner as previously restored or reestablished by distance and direction. Show the discrepancy on the plan view drawing. Show the distances between the corner as restored or reestablished, and (1) the corner as previously restored or reestablished – and (2) to at least two of the witness monuments shown on the previous drawing.

N/A

Was the corner restored through acceptance of (1) an obliterated evidence location, (2) a found perpetuated location, or (3) an existent corner location.

(2) a found perpetuated location

\* as per existing monuments from survey of record

Was the corner reestablished through lost corner proportionate methods? If so, show the method including the directions to other public land survey corners used as evidence or used for proportioning in determining the corner location.

N/A

Show the history of record in chronological order from Original Government Survey to present.

- (1) Original corner established by Parke, 1832.
- (2) Douglas Malliet of D.F.Burbach Municipal & Civil Engineers re-established the corner location by evidence of occupation and set a 2" iron pipe in 1983.  
(Survey recorded as Book I, Page 66 – Tie Sheet recorded at Page 103)

I, Jessica A. Zamor, do hereby certify that the corner location shown on this record was determined by me or under my direction and control and that this U.S. Public Land Survey Monument Record is correct to the best of my knowledge and belief.

*Jessica A. Zamor* 5-11-2000  
Jessica A. Zamor R.L.S. S-2310 Date

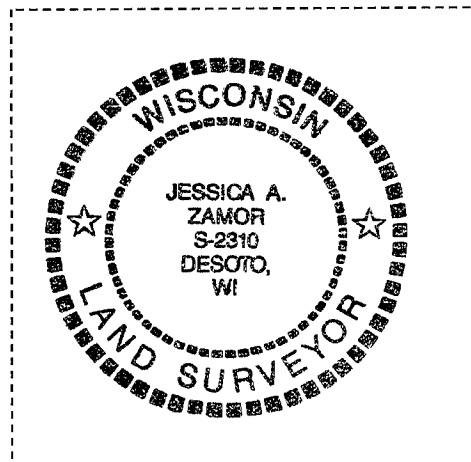

North Lancaster Townshp

# U.S. PUBLIC LAND SURVEY MONUMENT RECORD

CORNER DESCRIPTION: SW CORNER, SECTION 25, T 5 N, R 3 W

STATE PLANE COORDINATES: N \_\_\_\_\_, E \_\_\_\_\_

THETA ANGLE: \_\_\_\_\_

HORIZONTAL DATUM: WISCONSIN STATE PLANE COORDINATE SYSTEM, SOUTH ZONE

EVIDENCE: FOUND NORTH, SOUTH & WEST ANCIENT FENCE LINES & REMNANTS OF CORNER POST IN GROUND @ FENCE INTERSECTION; NO OTHER MONUMENT ON RECORD

MONUMENT: FOUND , PLACED   
METHOD OF RESTORATION (RE-ESTABLISHMENT):  
 ACCEPTED EXISTING MONUMENT  
N , E  ACCEPTED OCCUPATION  
N , E  LOST CORNER PROPORTIONATE METHODS  
DATE CORNER SET: 2-25-83

- LEGEND
- ▲ SET #6 REBAR, 1.13 LBS PER LINEAL FT. MIN. WT.
  - SET 1" X 24" IRON PIPE, 1.13 LBS PER LINEAL FT. MIN. WT.
  - SET 2" X 30" IRON PIPE, 3.65 LBS. PER LINEAL FT. MIN. WT.
  - FOUND 1" IRON PIPE
  - FOUND 2" IRON PIPE
  - FOUND R/R SPIKE
  - SET R/R SPIKE
  - ⊙ GOVERNMENT CORNER
  - EXISTING FENCE

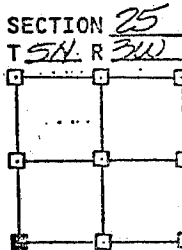
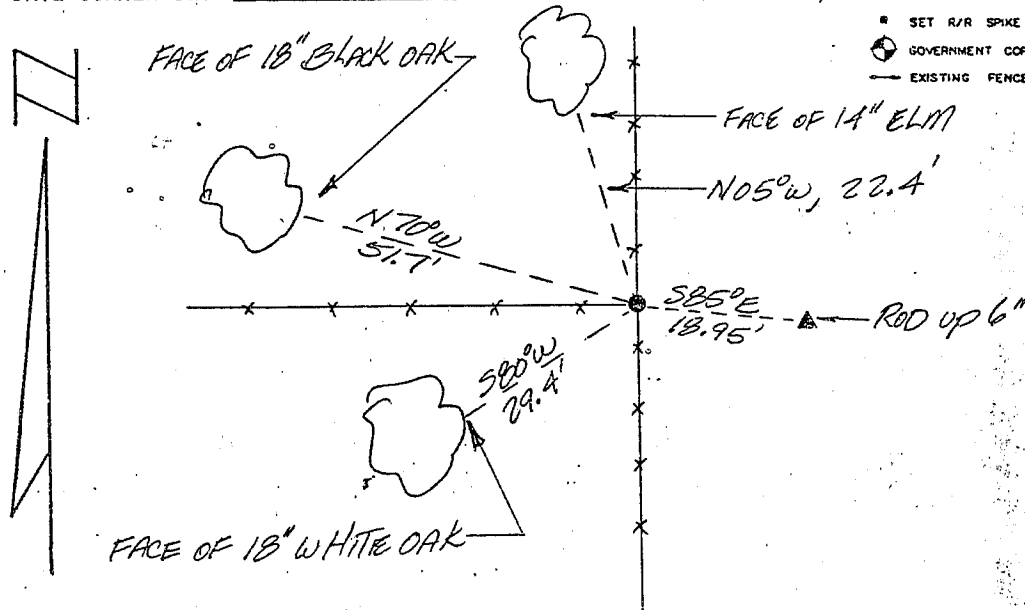

NOT TO SCALE THIS CONFORMS TO WISCONSIN ADMINISTRATIVE CODE A-E 5.02

### SURVEYOR'S AFFIDAVIT:

STATE OF WISCONSIN)  
GRANT COUNTY) SS

I hereby certify that I, Douglas J. Malliet, have complied with the Wisconsin State Statutes, Statutes of the United States, and the rules and regulations made by the Secretary of the Interior in the location of the corner shown above.

DATE OF SURVEY: 3-5-83

Douglas J. Malliet  
REGISTERED LAND SURVEYOR  
# 1260

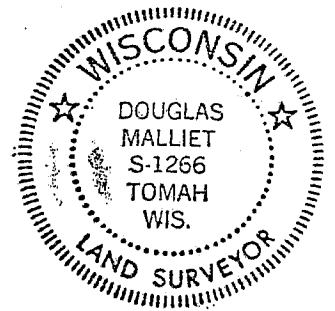

## D. F. BURBACH MUNICIPAL & CIVIL ENGINEERS

410 NORTH SECOND STREET • PLATTEVILLE, WISCONSIN 53818 • (608) 348-3262

MAY 24 1983

12103