

RECORDED

MAR 9 1988

U. S. PUBLIC LAND SURVEY MONUMENT RECORD

GRANT County, Wisconsin.

Basis for monument location.

Last reference to the corner was the original government survey. No evidence of the corner or its accessories could be located. Only evidence of the corner was that of a fence corner post with fencing running North and West. After traversing the Section I accepted the location of the fence corner as the best location for the corner and monument same.



Section 22, T 5 N, R 2 W

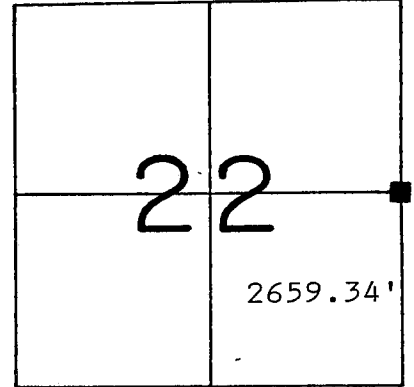

Corner Location
(Indicate by - ■)

Tie sketch

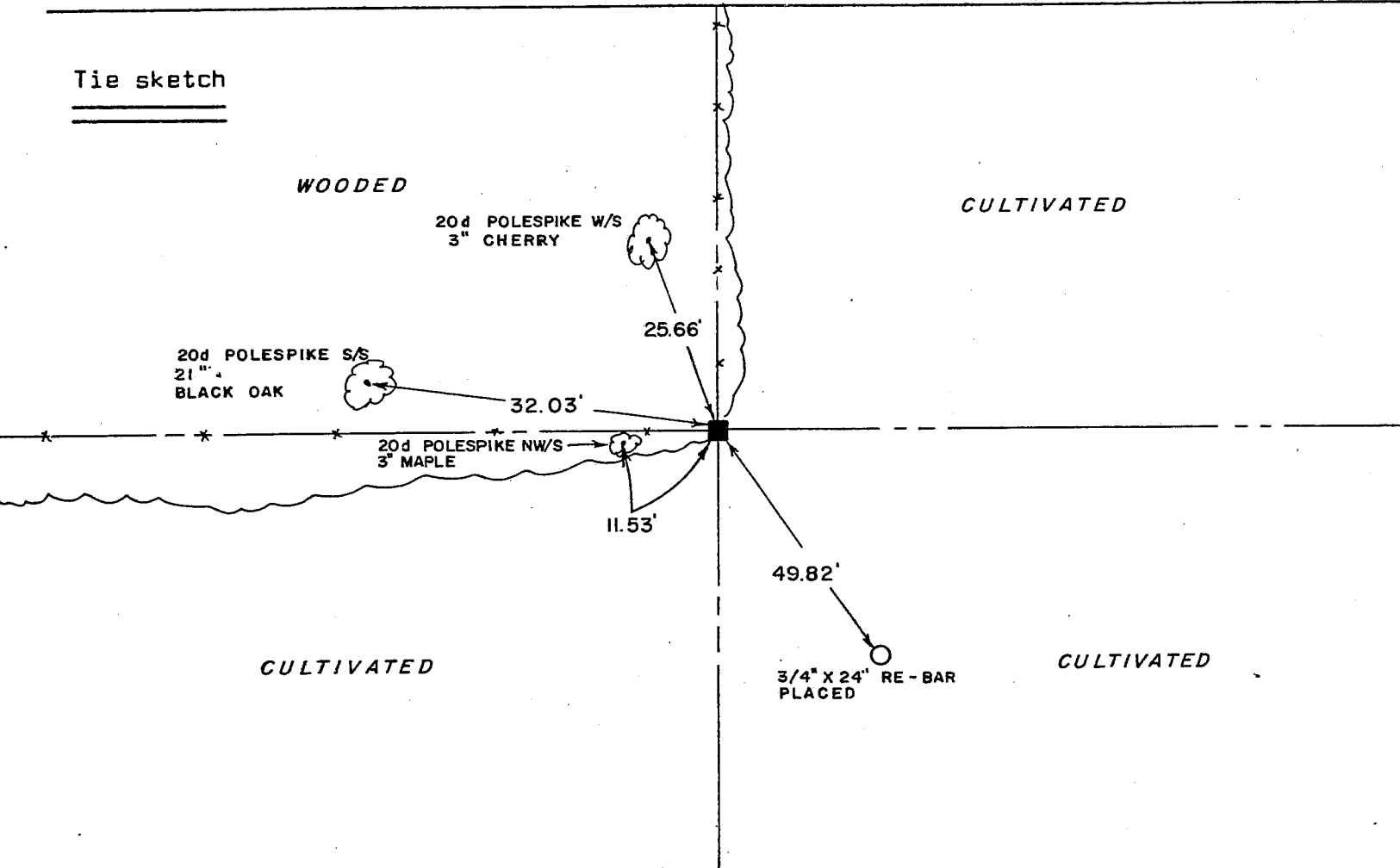

I, _____ Certify that the corner location shown hereon this record was determined by me or under my direction and control and that this U. S. Public Land Survey Monument Record is correct and complete to the best of my knowledge and belief.

3-8-88
Date

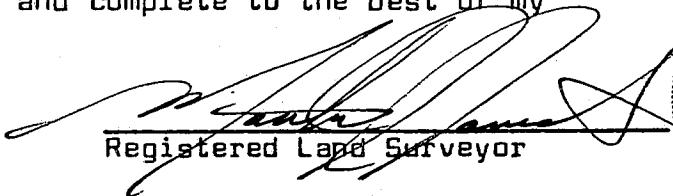
Registered Land Surveyor



P. 78