

# GRANT COUNTY

## Survey Monument Record

TYPE OF MONUMENT COUNTY MONUMENT  
 STATE PLANE COORDINATES: N \_\_\_\_\_  
 E \_\_\_\_\_  
 ELEVATION — M.S.L. DATUM: \_\_\_\_\_  
 THETA ANGLE: \_\_\_\_\_  
 FIELD BOOK: 9504  
 PAGE: 24

CORNER NO. 39  
 SECTION 11  
 TOWN 5N  
 RANGE 2W  
E 1/4 COR

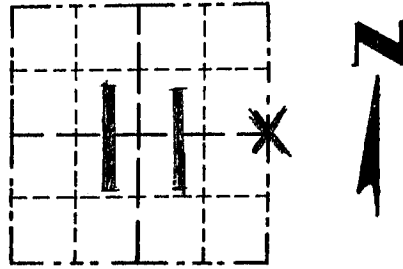

LOCATION  
 (Indicated by "X")

### BASIS FOR MONUMENT LOCATION

(Use reverse side if necessary)

Show info such as: History of corner, with reference to Vol. and pg., dates, surveyor; exact description of monument replaced; if location computed, by taped or EDM traverse; landowner, remarks, etc.

SEAL:

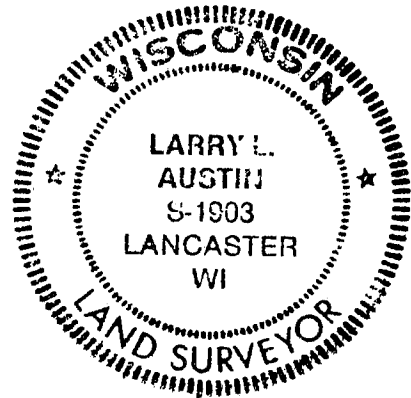

ORIGINAL CORNER SET  
 IN 1832 BY PARKE.  
 CORNER WAS USED BY  
 MACMILLAN ON A 1975 SURVEY;  
 I SET THE CORNER BASED ON  
 FOUND MONUMENTS FROM THAT  
 SURVEY; J.C. SCOTT MEASURED TO  
 THE CORNER IN 1881. THESE  
 SURVEYS MATCH AN OCCUPATIONAL  
 EVIDENCE LOCATION. THIS LOCATION  
 WAS VERIFIED BY EDM  
 TRAVERSE IN THE AREA

CERTIFIED CORRECT

*Larry L. Austin*  
 Registered Land Surveyor

DATE: 10/24/95

### TIE SKETCH

Show at least three (3) ties and monument

#### LEGEND

- ⊕ GRANT COUNTY ALUM. MONUMENT SET
- 1" x 12" MIN. IRON PIPE SET - TIES
- X — X — EXISTING FENCE

