

Survey Monument Record

CORNER NO. \_\_\_\_\_  
 SECTION 6 OCT 16 1995  
 TOWN 5N  
 RANGE 2W

TYPE OF MONUMENT Grant County drivable Aluminum monument

STATE PLANE COORDINATES: N \_\_\_\_\_  
 E \_\_\_\_\_

ELEVATION — M.S.L. DATUM: \_\_\_\_\_

THETA ANGLE: \_\_\_\_\_

FIELD BOOK: 95-5, 7 (955-181)

PAGE \_\_\_\_\_

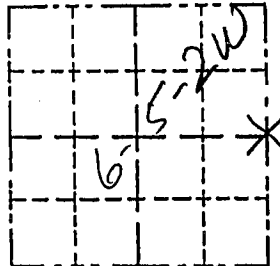

LOCATION  
 (Indicated by "X")

- FOUND PERPETUATED LOCATION
- OBLITERATED EVIDENCE LOCATION
- LOST CORNER (RESTORED BY PROPORTIONATE METHODS)

BASIS FOR MONUMENT LOCATION

(Use reverse side if necessary)

Show info such as: History of corner, with reference to Vol. and pg., dates, surveyor; exact description of monument replaced; if location computed, by taped or EDM traverse; landowner, remarks, etc.

There are no recent survey records of this corner. The occupied location of fences to north and east and a line of "broken off" Iron Pipe fence posts to west was accepted and monumented after an EDM traverse of the surrounding sections.

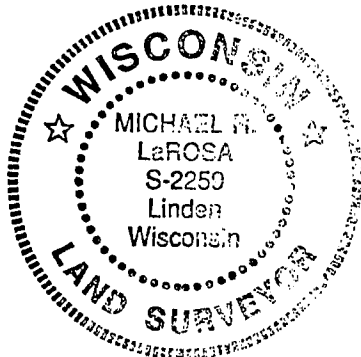

CERTIFIED CORRECT TO THE BEST OF MY KNOWLEDGE AND BELIEF

Michael R. LaRosa  
 Registered Land Surveyor

DATE: 8/29/95

TIE SKETCH

Show at least three (4) ties and monument

