

GRANT COUNTY

Survey Monument Record

TYPE OF MONUMENT COUNTY MONUMENT
 STATE PLANE COORDINATES: N _____
 E _____
 ELEVATION — M.S.L. DATUM: _____
 THETA ANGLE: _____
 FIELD BOOK: 9504
 PAGE 25

CORNER NO. 24
 SECTION 11
 TOWN 5N
 RANGE ZW
N 1/4 COR

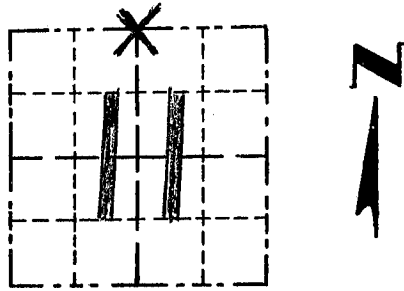

LOCATION
 (Indicated by "X")

BASIS FOR MONUMENT LOCATION

(Use reverse side if necessary)

Show info such as: History of corner, with reference to Vol. and pg., dates, surveyor; exact description of monument replaced; if location computed, by taped or EDM traverse; landowner, remarks, etc.

ORIGINAL CORNER SET
 IN 1832 BY PARKE.
 NO RECORD FOUND OF THE
 CORNER SINCE THE ORIGINAL
 SURVEYS; CORNER LOCATION
 BASED ON OCCUPATIONAL
 EVIDENCE & VERIFIED BY
 EDM TRAVERSE OF THE
 AREA.

SEAL:

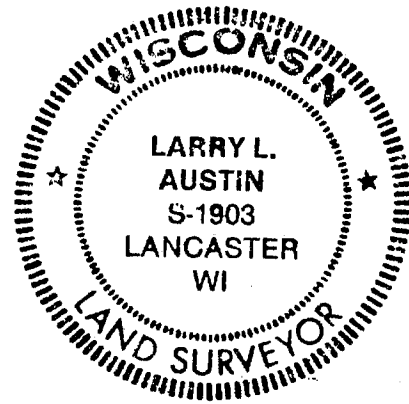

CERTIFIED CORRECT

Larry L. Austin
 Registered Land Surveyor

DATE: 10/24/95

TIE SKETCH

Show at least three (3) ties and monument

LEGEND

- ⊕ GRANT COUNTY ALUM. MONUMENT SET
- 1" X 1/2" IRON PIPES SET = TIES
- ✕✕ EXISTING FENCE

