

GRANT COUNTY

Survey Monument Record

TYPE OF MONUMENT COUNTY MONUMENT

STATE PLANE COORDINATES: N _____
E _____

ELEVATION — M.S.L. DATUM: _____

THETA ANGLE: _____

FIELD BOOK: 9504

PAGE 26

CORNER NO. 23

SECTION 11

TOWN 5N

RANGE ZW
NE COR

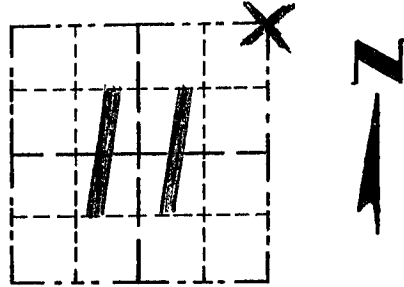

LOCATION
(Indicated by "X")

BASIS FOR MONUMENT LOCATION

(Use reverse side if necessary)

Show info such as: History of corner, with reference to Vol. and pg., dates, surveyor; exact description of monument replaced; if location computed, by taped or EDM traverse; landowner, remarks, etc.

SEAL:

- ORIGINAL CORNER SET IN 1832 BY PARKE
- CORNER WAS DIMENSIONED AT 40.06 CH No. OF E 1/4 CORNER ON A 1870 SURVEY. I ACCEPTED AN E-W FENCE FOR THE N-S LOCATION & set the corner AT RECORDED DIST FROM THE N 1/4 CORNER OF 40.08 ch.

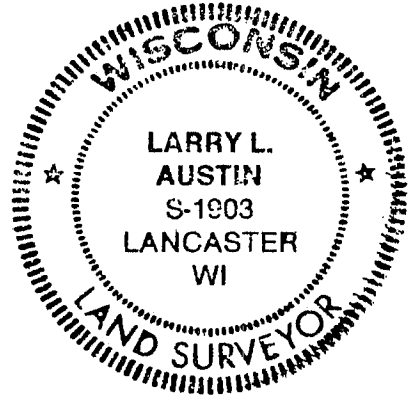

CERTIFIED CORRECT

Larry L. Austin
Registered Land Surveyor

DATE: 10/24/95

TIE SKETCH

Show at least three (3) ties and monument

