

Survey Monument Record

TYPE OF MONUMENT P.K. Nail set
 STATE PLANE COORDINATES: N _____
 E _____
 ELEVATION — M.S.L. DATUM: _____
 THETA ANGLE: _____
 FIELD BOOK: 95-9
 PAGE 953-309, 347

CORNER NO. _____
 SECTION 17
 TOWN 510
 RANGE 1W

BASIS FOR MONUMENT LOCATION

(Use reverse side if necessary)

Show info such as: History of corner, with reference to Vol. and pg., dates, surveyor; exact description of monument replaced; if location computed, by taped or EDM traverse; landowner, remarks, etc.

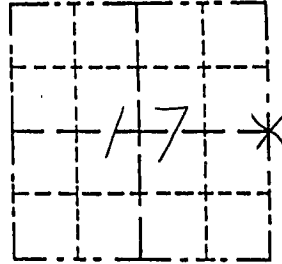

LOCATION
 (Indicated by "X")

- FOUND PERPETUATED LOCATION
- OBSOLETE EVIDENCE LOCATION
- LOST CORNER (RESTORED BY PROPORTIONATE METHODS)

A P.K. nail was placed in line with the center line of County Trunk Highway D to the south and in line with a fence line to the east as called for in Plat of surveys by D.C. Dixon dated 9/8/1977 and Homer Ralph dated 12/29/1970 and verified by its relationships to surrounding corners. (SEE PLAT OF SURVEY FOR ARNIE ROOPER, DAVE RUNDALL AND PAT GRISWOLD FOR SECTION SUMMARY)

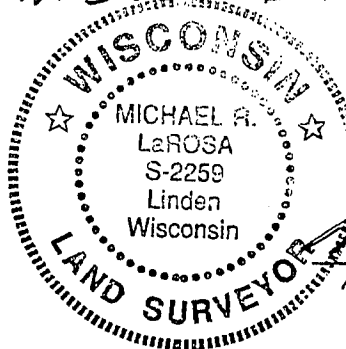

CERTIFIED CORRECT TO THE BEST OF MY KNOWLEDGE AND BELIEF

Michael R. LaRosa
 Registered Land Surveyor

DATE: 11/6/1995

TIE SKETCH

Show at least three (4) ties and monument

