

Survey Monument Record

CORNER NO. \_\_\_\_\_  
 SECTION 16  
 TOWN 5N  
 RANGE 1W

TYPE OF MONUMENT 1" Iron Pipe  
 STATE PLANE COORDINATES: N \_\_\_\_\_  
 E \_\_\_\_\_  
 ELEVATION — M.S.L. DATUM: \_\_\_\_\_  
 THETA ANGLE: \_\_\_\_\_  
 FIELD BOOK: 95-9  
 PAGE 955-309, 347

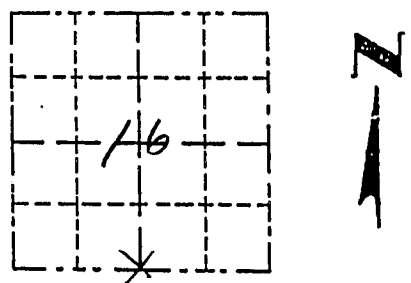

BASIS FOR MONUMENT LOCATION

(Use reverse side if necessary)  
 Show info such as: History of corner, with reference to Vol. and pg., dates, surveyor; exact description of monument replaced; if location computed, by taped or EDM traverse; landowner, remarks, etc.

LOCATION  
 (Indicated by "X")  
 FOUND PERPETUATED LOCATION  
 OBLITERATED EVIDENCE LOCATION  
 LOST CORNER (RESTORED BY PROPORTIONATE METHODS)

There are no recent survey records of this corner. The occupied location of a 3 way fence intersection was accepted and monumented after it fit well with proportional relationships to surrounding corners and with occupied subdivided corners in the area. (See PLAT OF SURVEY FOR ARNIE ROBER, DAVID RUNDALL AND PAT BRISWOLD FOR SECTION SUMMARY (THIS DATE))

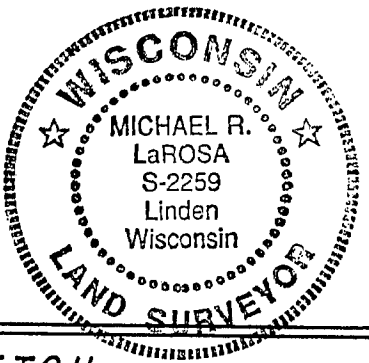

CERTIFIED CORRECT TO THE BEST OF MY KNOWLEDGE AND BELIEF  
Michael R. LaRosa  
 Registered Land Surveyor  
 DATE: 11/6/1995

TIE SKETCH

Show at least three (4) ties and monument

