

Survey Monument Record

TYPE OF MONUMENT 1-1/4" Iron Pipe
 STATE PLANE COORDINATES: N _____
 E _____
 ELEVATION — M.S.L. DATUM: _____
 THETA ANGLE: _____
 FIELD BOOK: 95-6
 PAGE _____

CORNER NO. _____
 SECTION 16 OCT 16
 TOWN SN
 RANGE 1W

BASIS FOR MONUMENT LOCATION

(Use reverse side if necessary)

Show info such as: History of corner, with reference to Vol. and pg., dates, surveyor; exact description of monument replaced; if location computed, by taped or EDM traverse; landowner, remarks, etc.

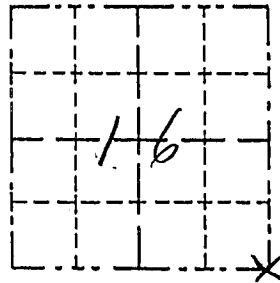

LOCATION

(Indicated by "X")

- FOUND PERPETUATED LOCATION
- OBLITERATED EVIDENCE LOCATION
- LOST CORNER (RESTORED BY PROPORTIONATE METHODS)

The occupied location of a 3 way fence intersection was accepted after an E.D.M. traverse of the area. Relationships between this corner and corners north checked out well with Sampson's record (Survey dated 6/10/1899).

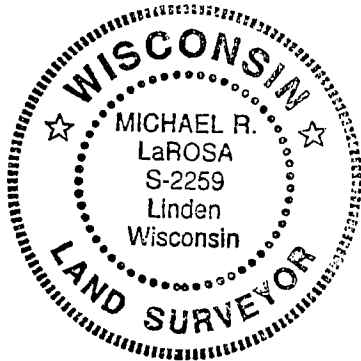

CERTIFIED CORRECT TO THE BEST OF MY KNOWLEDGE AND BELIEF

Michael R. LaRosa

Registered Land Surveyor

DATE: 7/24/1995

TIE SKETCH

Show at least three (4) ties and monument

