

Survey Monument Record

TYPE OF MONUMENT RAILROAD SPIKE  
SET.

CORNER NO. 123  
SECTION 36  
TOWN 4N  
RANGE 4W

FIELD BOOK: 96-20  
PAGE (10)

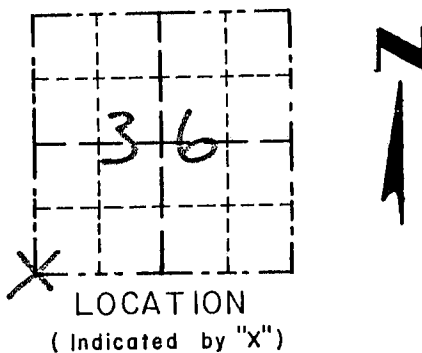

BASIS FOR MONUMENT LOCATION

(Use reverse side if necessary)

Show info such as: History of corner, with reference to Vol. and pg., dates, surveyor; exact description of monument replaced; if location computed, by taped or EDM traverse; landowner, remarks, etc.

CORNER SET IN 1832 BY SIBLEY. NO RECORD OF CORNER FOUND SINCE ORIGINAL SURVEYS. I SET THE CORNER ONLINE BETWEEN AN EXISTING NORTH / SOUTH FENCE FOR EASTING; NORTHING WAS SET BY AN EXISTING EAST / WEST ROAD. I VERIFIED THIS LOCATION USING EDM METHODS.

SEAL:

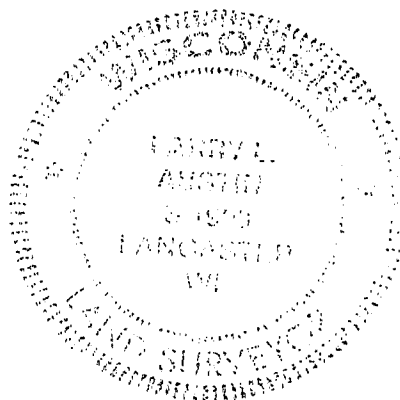

CERTIFIED CORRECT

*[Signature]*  
Registered Land Surveyor

DATE: 1/12/98

TIE SKETCH

Show at least three (3) ties and monument

LEGEND

- ⊕ RAILROAD SPIKE SET
- 3/4" X 24" IRON BAR SET
- 1/2" X 15" IRON BAR SET
- xx EXISTING FENCE FIELDS

