

Survey Monument Record

TYPE OF MONUMENT 3/4" x 24" IRON BAR
SET WITH GRANT COUNTY CAP

CORNER NO. 38
 SECTION 11
 TOWN 4N
 RANGE 4W

FIELD BOOK: 96-04
 PAGE 15

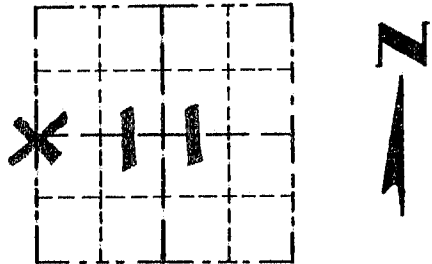

LOCATION
 (Indicated by "X")

BASIS FOR MONUMENT LOCATION

(Use reverse side if necessary)

Show info such as: History of corner, with reference to Vol. and pg., dates, surveyor; exact description of monument replaced; if location computed, by taped or EDM traverse; landowner, remarks, etc.

SEAL:

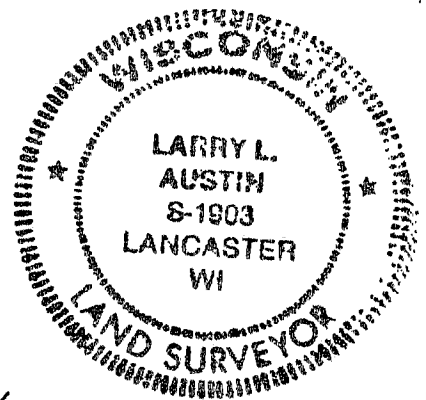

NO RECORD FOUND SINCE ORIGINAL SURVEY IN 1833 BY CLARK. THE N-S LOCATION OF THE CORNER WAS SET EQUIDISTANT TO NW & SW CORNERS OF THE SECTION; E-W LOCATION BASED ON PROJECTION OF A FENCE FROM THE SOUTH. THIS LOCATION VERIFIED BY EDM TRAVERSE OF THE AREA.

CERTIFIED CORRECT

Larry L. Austin
 Registered Land Surveyor

DATE: 7/17/96

TIE SKETCH

Show at least three (3) ties and monument

