

U.S. PUBLIC LAND SURVEY MONUMENT RECORD

Section 34, Town 4 North Range 3 West, Town of South Lancaster, Grant County, Wisconsin

CERTIFICATE

I, Larry L. Austin, do hereby certify that the corner location on this record was determined by me and/or under my direct supervision and that this U.S. public land survey monument record is correct and complete to the best of my knowledge and belief.

Larry L. Austin
 Larry L. Austin, S-1903



● = CORNER LOCATION

HISTORY OF CORNER

Corner was originally set in 1832 by Robert Clark. In 1843 Freeman tied to the original corner. In 1858 Hayden tied to the original corner. No other record of the corner was found.

CORNER EVIDENCE FOUND

I set the corner in center of the township road for Northing. Easting was established proportionately between the occupied Northeast and Northwest corners of Section 34. Verified this location using EDM & GPS methods.

DESCRIPTION OF CORNER AND WITNESS MONUMENTS, references and accessories used to perpetuate the original or re-established location of this corner. Witnesses to monument location Bobby Sedgwick & Brad Digman & Shane Austin

SKETCH:

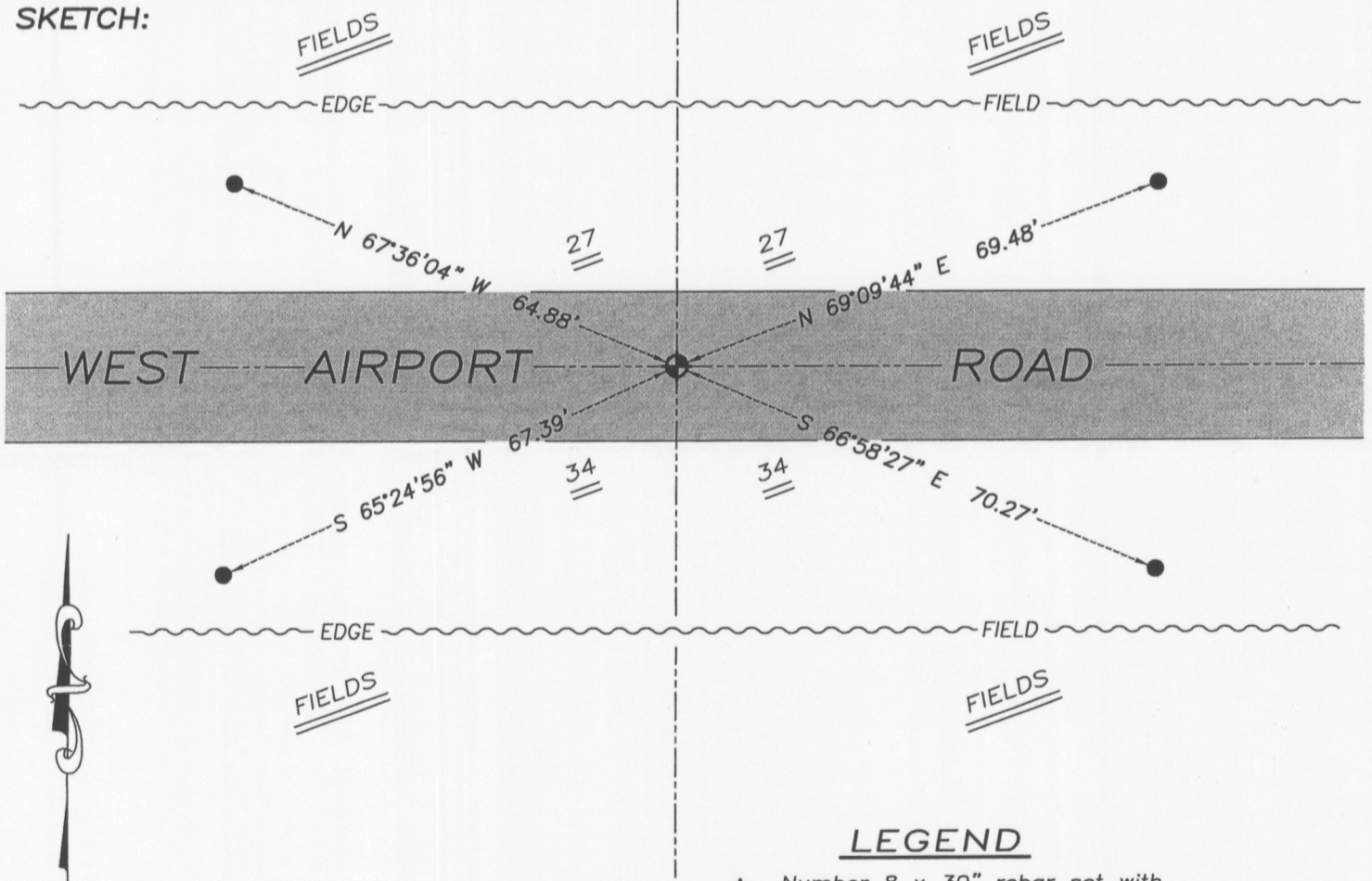

LEGEND

- ⊕ Number 8 x 30" rebar set with Grant County Aluminum cap
- Number 4 x 24" Rebar set with red plastic "TIE" cap
- *— Approximate existing fence

NOT TO SCALE



Austin Engineering LLC

austinengineeringllc.com
 4211 HWY 81 E, LANCASTER, WI 53813
 PHONE: 608-723-6363 FAX: 608-723-6702

JOB NUMBER 10S203-GRANEY
 FIELDBOOK: TDSR, 10-01
 G:\T3NR3W\T3NR3W
 H:\TIE\T4NR3W\106

DRAWN BY: SW AUSTIN
 APPROVED: LL AUSTIN

106

FEB 18 2011