

CERTIFIED LAND CORNER

STATE OF WISCONSIN) S.S.
 COUNTY OF GRANT)

I, LAURENCE E. SCHMIT, do hereby certify that on the 28th day of Oct 1983, I found (evidence) (~~no evidence~~) of the W 1/4 corner of Sec 5, T4N, R2W, Fourth Principal Meridian, and I ~~re-established~~ perpetuated said corner according to the Wisconsin Statutes as shown and described hereon.

Dated this 31 day of October 1983

Laurence E. Schmit
 Title

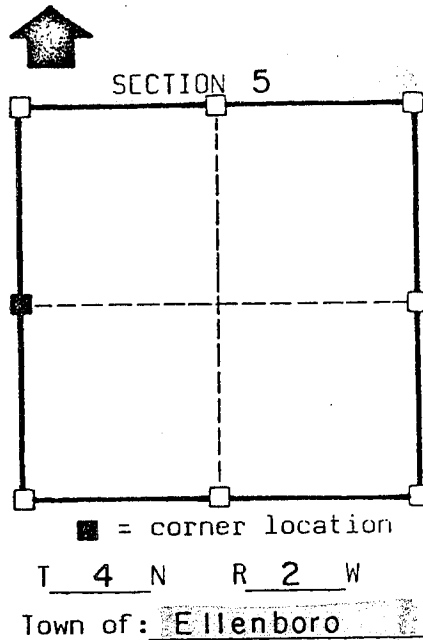

Seal

History of original corner establishment:

Original Gov't Survey
Survey for Gene & Darlene Meyers dated 6-11-83
Survey # Brian Fager dated 7-6-1977 Survey for Ken Johnson dated June 11

Description of corner evidence found:

1" Iron pipe

Description of corner and witness monuments, references and accessories used to perpetuate the original or re-established location of this corner:

Witnesses to corner location:

JAMES OLSON RLS
KEVIN REVER

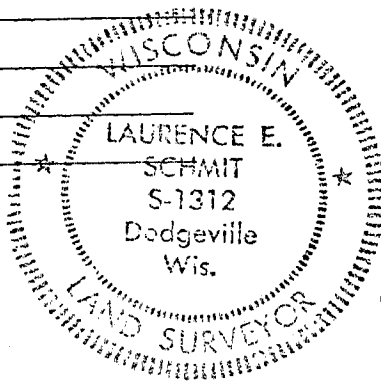

Sketch:

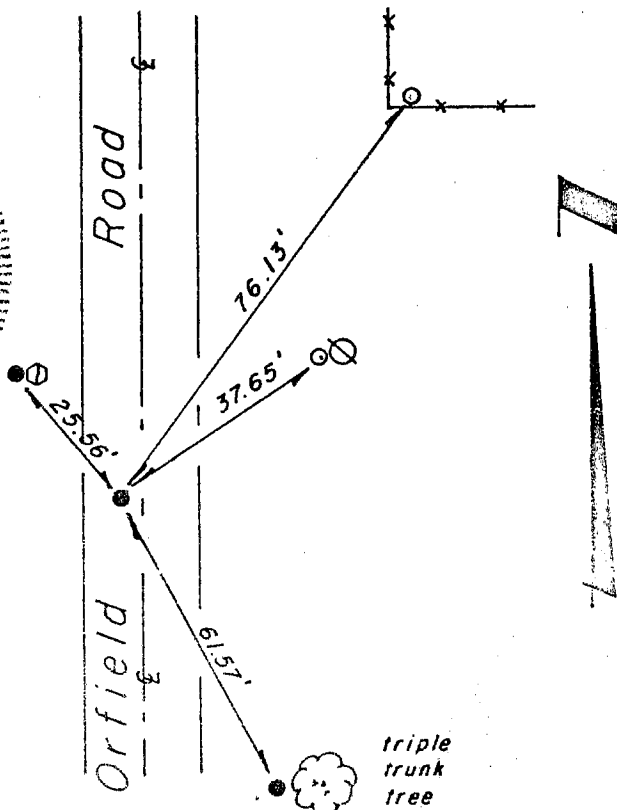

Legend

- 1" Ø Iron pipe
- 1-1/2" Ø Iron pipe
- ⊕ Telephone pedestal
- ⊙ Power pole
- Fenceline

SURVEY CONTROL TABLE

Horizontal		Vertical		WISCONSIN COORDINATE SYSTEM	
Corner	East (X)	North (Y)	Elevation (Z)	Zone	Zone
Control No.	Name				