

# GRANT COUNTY

## Survey Monument Record

TYPE OF MONUMENT RAILROAD SPIKE FOUND  
 STATE PLANE COORDINATES: N \_\_\_\_\_  
 E \_\_\_\_\_  
 ELEVATION — M.S.L. DATUM: \_\_\_\_\_  
 THETA ANGLE: \_\_\_\_\_  
 FIELD BOOK: \_\_\_\_\_  
 PAGE \_\_\_\_\_

CORNER NO. 115  
 SECTION 32  
 TOWN 4 N  
 RANGE 1 W  
W 1/4 COR

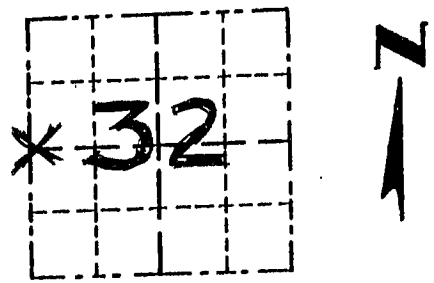

LOCATION  
(Indicated by "X")

### BASIS FOR MONUMENT LOCATION

(Use reverse side if necessary)  
 Show info such as: History of corner, with reference to Vol. and pg., dates, surveyor; exact description of monument replaced; if location computed, by taped or EDM traverse; landowner, remarks, etc.

SEAL:

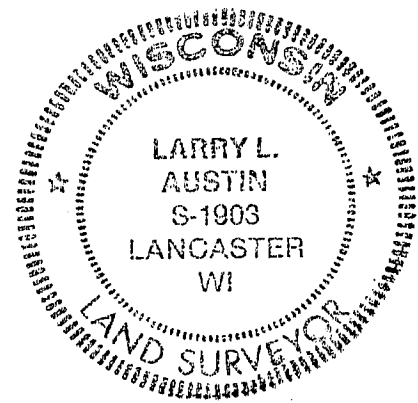

ORIG. CORNER SET IN 1833  
 BY CLARK; NO RECORD OF  
 CORNER FD. SINCE ORIGINAL  
 SURVEYS; FOUND EXISTING RR SPIKE AT  
 OCCUPIED LOCATION & VERIFIED IT  
 BY EDM TRAVERSE OF THE  
 AREA.

CERTIFIED CORRECT  
*Larry L. Austin*  
 Registered Land Surveyor  
 DATE: 2/16/95

### TIE SKETCH

Show at least three (3) ties and monument

#### LEGEND

- ▲ RAILROAD SPIKE FOUND = COR.
- 1" x 12" IRON PIPE SET = TIE
- X — X — EXISTING FENCE

