

GRANT COUNTY

Survey Monument Record

TYPE OF MONUMENT GRANT COUNTY Alum. Mon.
 STATE PLANE COORDINATES: N _____
 E _____
 ELEVATION — M.S.L. DATUM: _____
 THETA ANGLE: _____
 FIELD BOOK: 92-17 / 94-21
 PAGE 23

CORNER NO. 103
 SECTION 36
 TOWN 4 N
 RANGE 1 W

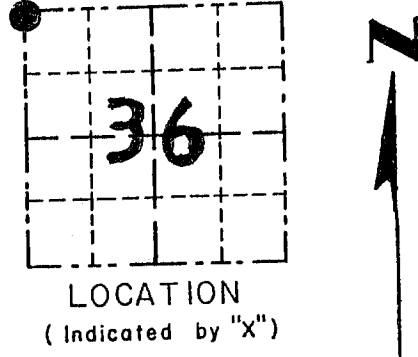

BASIS FOR MONUMENT LOCATION

(Use reverse side if necessary)

Show info such as: History of corner, with reference to Vol. and pg., dates, surveyor; exact description of monument replaced; if location computed, by taped or EDM traverse; landowner, remarks, etc.

SEAL:

CORNER WAS ORIGINALLY ESTABLISHED IN 1833 BY ROBERT CLARK. NO RECORD OF CORNER FOUND SINCE. CORNER WAS REESTABLISHED BY OCCUPATION EVIDENCE AND VERIFIED BY EDM TRAVERSE OF AREA.

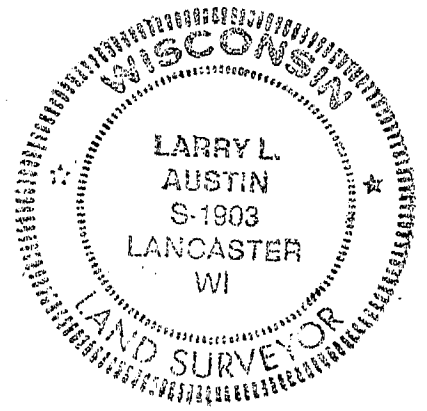

CERTIFIED CORRECT

Larry L. Austin
 Registered Land Surveyor

DATE: 2/12/95

TIE SKETCH

Show at least three (3) ties and monument

- LEGEND
- GRANT COUNTY Alum. Mon. PLACED
 - 1" x 24" IRON PIPES PLACED AS TIES
 - ** EXISTING FNC

