

# GRANT COUNTY

## Survey Monument Record

TYPE OF MONUMENT GRANT COUNTY Alum. Mon.  
 STATE PLANE COORDINATES: N \_\_\_\_\_  
 E \_\_\_\_\_  
 ELEVATION — M.S.L. DATUM: \_\_\_\_\_  
 THETA ANGLE: \_\_\_\_\_  
 FIELD BOOK: \_\_\_\_\_  
 PAGE \_\_\_\_\_

CORNER NO. 59  
 SECTION 14  
 TOWN 4N  
 RANGE 1W  
E 1/4 Cor

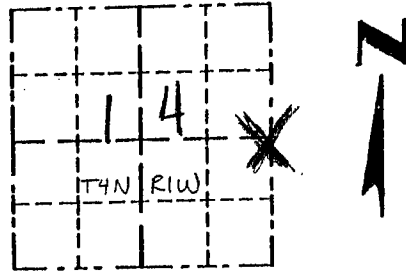

LOCATION  
(Indicated by "X")

### BASIS FOR MONUMENT LOCATION

(Use reverse side if necessary)

Show info such as: History of corner, with reference to Vol. and pg., dates, surveyor; exact description of monument replaced; if location computed, by taped or EDM traverse; landowner, remarks, etc.

SEAL:

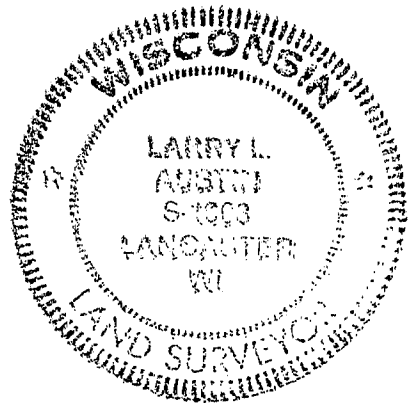

CORNER WAS ORIGINALLY SET  
BY ROBERT CLARK IN 1833;  
NO RECORD FOUND OF CORNER  
SINCE ORIGINAL SURVEYS; I SET  
THE MONUMENT AT OCCUPIED  
LOCATION AFTER EDM TRAVERSE  
OF THE AREA

CERTIFIED CORRECT

Larry L. Austin  
 Registered Land Surveyor

DATE: 9/15/95

### TIE SKETCH

Show at least three (3) ties and monument.

