

# GRANT COUNTY

## Survey Monument Record

TYPE OF MONUMENT STONE FOUND  
 STATE PLANE COORDINATES: N \_\_\_\_\_  
 E \_\_\_\_\_  
 ELEVATION — M.S.L. DATUM: \_\_\_\_\_  
 THETA ANGLE: \_\_\_\_\_  
 FIELD BOOK: 96-05  
 PAGE: (22)

CORNER NO. 77  
 SECTION 22  
 TOWN 3N  
 RANGE 2W

### BASIS FOR MONUMENT LOCATION

(Use reverse side if necessary)

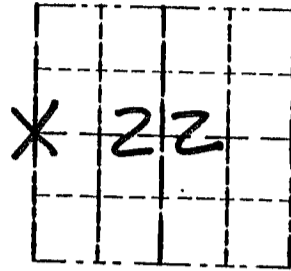

LOCATION  
(Indicated by "X")



CORNER SET IN 1833 BY  
 ROBERT CLARK. IN 1898 SEAL:  
 CHARLES SIMPSON SET  
 A STONE AT THIS LOCATION.  
 I FOUND AND ACCEPTED  
 THE STONE AT A OCCUPIED  
 FENCE CORNER. VERIFIED ITS  
 LOCATION USING EDM METHODS.

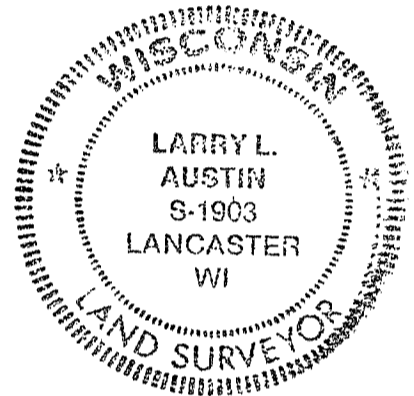

CERTIFIED CORRECT

*Larry L. Austin*  
 Registered Land Surveyor

DATE: 8/21/96

### TIE SKETCH

Show at least three (3) ties and monument

