

GRANT COUNTY

Survey Monument Record

TYPE OF MONUMENT STONE FND,
 STATE PLANE COORDINATES: N _____
 E _____
 ELEVATION — M.S.L. DATUM: _____
 THETA ANGLE: _____
 FIELD BOOK: 96-05
 PAGE: 22

CORNER NO. 88
 SECTION 21
 TOWN 3N
 RANGE 2W

BASIS FOR MONUMENT LOCATION

(Use reverse side if necessary)

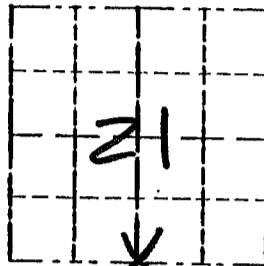

LOCATION
(Indicated by "X")



CORNER SET IN 1833 BY
 ROBERT CLARK, IN 1898
 CHARLES SAMPSON SEAL:
 SURVEYED E 1/2 SEC 21, W 1/2 SEC 22
 OF T3N R2W AND HE SET A
 ROCK OFF THE ORIGINAL BEARING
 TREES. I LOCATED THIS ROCK
 AT A OCCUPIED FENCE CORNER,
 VERIFIED ITS LOCATION USING
 EDM METHODS.

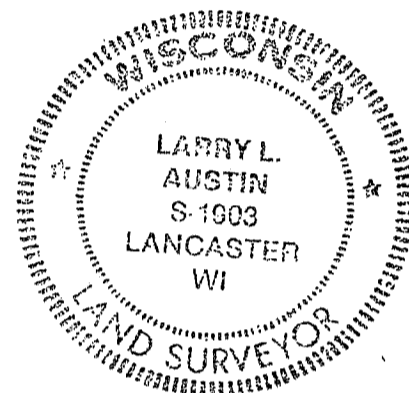

CERTIFIED CORRECT

Larry L. Austin
 Registered Land Surveyor
 DATE: 8/21/96

TIE SKETCH

Show at least three (3) ties and monument.

LEGEND

- ⊕ STONE FOUND
- 1/2" X 15" IRON BAR SET
- ** EXISTING FNC

