

CORNER DESCRIPTION: E 1/4 CORNER, SECTION 15, T 3 N, R 2 W

Harrison
Twp

STATE PLANE COORDINATES: N _____, E _____

THETA ANGLE: _____

HORIZONTAL DATUM: WISCONSIN STATE PLANE COORDINATE SYSTEM, SOUTH ZONE

EVIDENCE: EXISTING NORTH-SOUTH FENCE VELY STRAIGHT, NOT MOVED FOR 30-40 YEARS, MINIMUM, AS PER PAROLE EVIDENCE.

MONUMENT: FOUND , PLACED
METHOD OF RESTORATION (RE-ESTABLISHMENT):
 ACCEPTED EXISTING MONUMENT
N , E ACCEPTED OCCUPATION
N , E LOST CORNER PROPORTIONATE METHODS
DATE CORNER SET: 12/16/85

LEGEND

- ▲ SET #6 REBAR, 1.13 LBS PER LINEAL FT. MIN. WT
- SET 1" X 24" IRON PIPE, 1.13 LBS PER LINEAL FT. MIN. WT
- SET 2" X 30" IRON PIPE, 3.65 LBS. PER LINEAL FT. MIN. WT
- FOUND 1" IRON PIPE
- FOUND 2" IRON PIPE
- FOUND R/R SPIKE
- SET R/R SPIKE
- ⊙ GOVERNMENT CORNER
- EXISTING FENCE

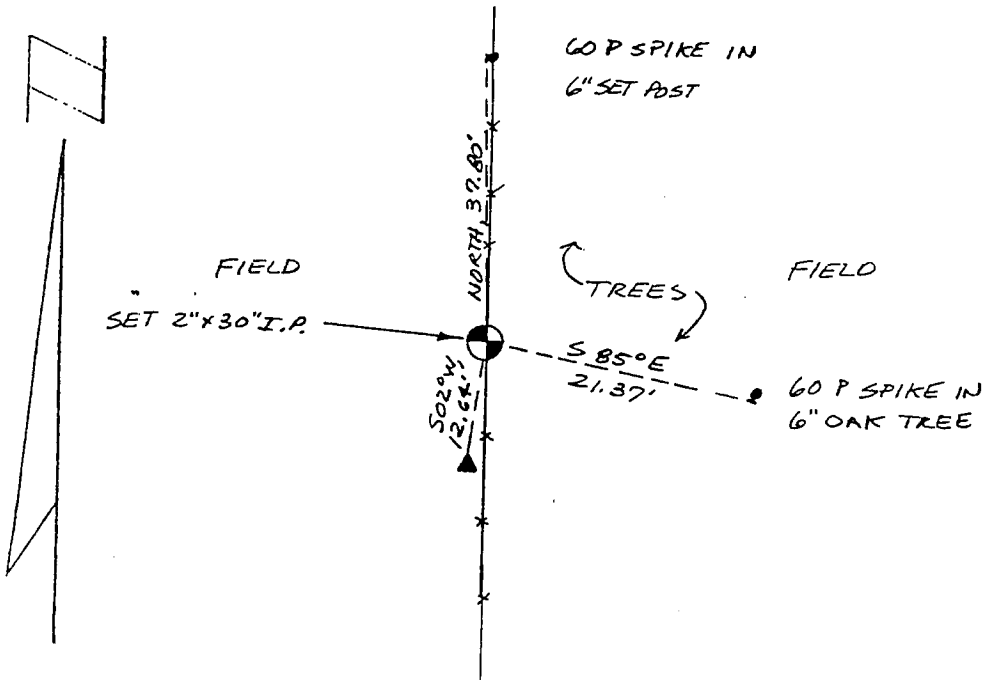

SECTION 15
T 3 N, R 2 W

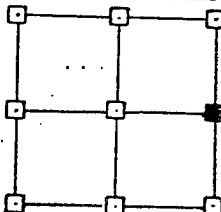

NOT TO SCALE THIS CONFORMS TO WISCONSIN ADMINISTRATIVE CODE A-E 5.02

SURVEYOR'S AFFIDAVIT:
STATE OF WISCONSIN)
GRANT COUNTY) SS

I hereby certify that I, _____, have complied with the Wisconsin State Statutes, Statutes of the United States, and the rules and regulations made by the Secretary of the Interior in the location of the corner shown above.

DATE OF SURVEY: 12/16/85

Douglas J. Mallon
REGISTERED LAND SURVEYOR
1260

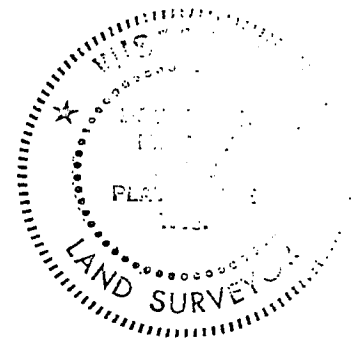

D. F. BURBACH MUNICIPAL & CIVIL ENGINEERS

410 NORTH SECOND STREET • PLATTEVILLE, WISCONSIN 53818 • (608) 348-3262

1-58