

MAY 25 1990

PL

# GRANT COUNTY

## GOVERNMENT CORNER RECORD

EAST 1/4 CORNER, SECTION 9, TOWNSHIP 3 NORTH, RANGE 1 EAST - WEST,  
TOWN, ~~CITY OR VILLAGE~~ OF PLATTEVILLE, RICHLAND CO.

TYPE OF MONUMENT: STONE W/CHISELED CROSS ELEVATION - M.S.L. DATUM \_\_\_\_\_

STATE PLANE COORDINATES: N \_\_\_\_\_

WISCONSIN SOUTH ZONE E \_\_\_\_\_

WITNESSES TO CORNER LOCATION

SEAN M. WALSH

PATRICK J. DEDERICH

SECTION 9, T 3 N, R 1 EW  
TOWN OF PLATTEVILLE

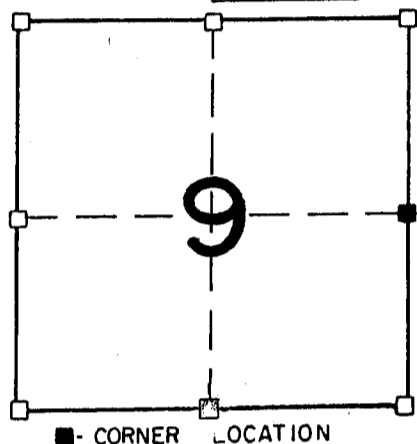

NORTH

TIE SKETCH  
(SHOW ALL HELPFUL FEATURES)

FIELD

VACANT LOT

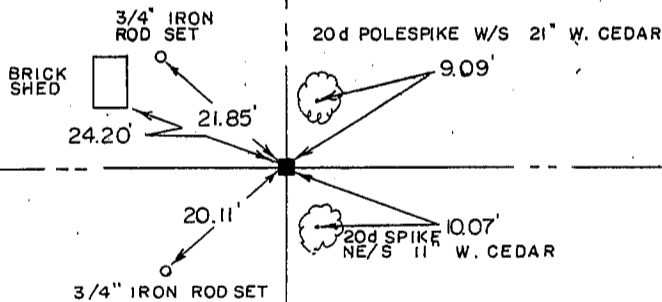

CHURCH LOT

YARD

SURVEYOR'S CERTIFICATE  
STATE OF WISCONSIN)  
RICHLAND COUNTY )SS

SEAL S - 1454

I, Matthew J. Janiak, DO HEREBY CERTIFY THAT the above corner has been  
perpetuated in accordance with the information contained hereon and  
that this information is correct and true to the best of my information,  
knowledge and belief. This location was accepted based on the physical  
location of the stone and the fact that it has been used and regarded  
as the corner since 1874.

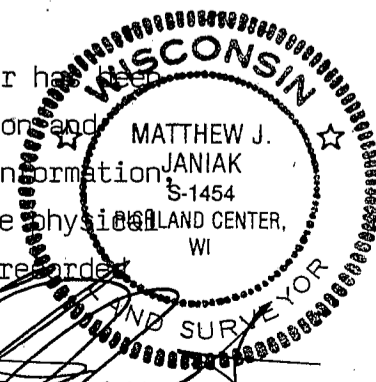

DATED THIS 16th DAY OF MAY, 19 90

REGISTERED LAND SURVEYOR

CORNER CODE

137