

Survey Monument Record

CORNER NO. 51  
 SECTION 8  
 TOWN 3N  
 RANGE 1W

TYPE OF MONUMENT 1" IRON PIPE FOUND  
 STATE PLANE COORDINATES: N \_\_\_\_\_  
 E \_\_\_\_\_  
 ELEVATION — M.S.L. DATUM: \_\_\_\_\_  
 THETA ANGLE: \_\_\_\_\_  
 FIELD BOOK: 9609  
 PAGE \_\_\_\_\_

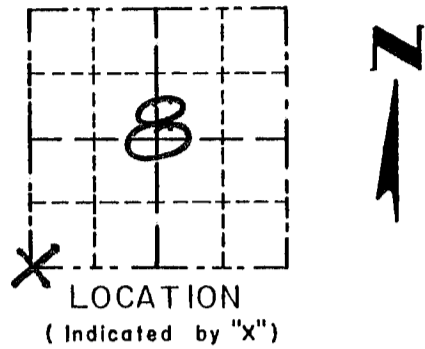

BASIS FOR MONUMENT LOCATION

(Use reverse side if necessary)

CORNER SET IN 1833 BY ROBERT CLARK. NO RECORD OF CORNER FOUND SINCE ORIGINAL SURVEYS. 1" IRON PIPE FOUND AT A OCCUPIED FENCE CORNER. ACCEPTED ITS LOCATION AFTER EDM TRAVERSE OF AREA.

SEAL:

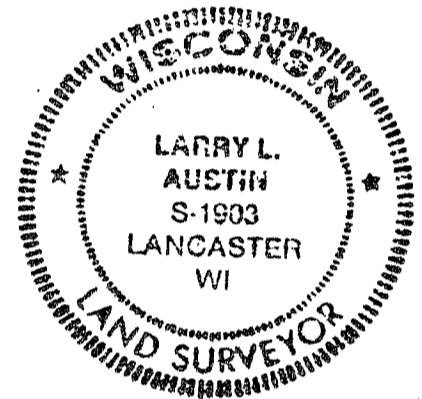

CERTIFIED CORRECT

*Larry L. Austin*  
 Registered Land Surveyor  
 DATE: 8/27/96

TIE SKETCH

Show at least three (3) ties and monument

LEGEND

- ⊕ 1" IRON PIPE FOUND
- 1/2" x 18" IRON BAR SET
- XX EXISTING FENCE

