

U. S. PUBLIC LAND SURVEY MONUMENT RECORD

GRANT County, Wisconsin.

Basis for monument location.

Government survey of township was done in 1832-1833 by Lucius Lyon. This was the last recorded information of the corner being monumented. No subsequent surveys could be located that were referenced to this corner. Position of corner was determined by occupational evidence. The corner was set at the intersection of the existing fence lines from the South and the West. This position appeared to be the best possible location and I monumented it as shown below.



Section 1, T2 N, R 2W

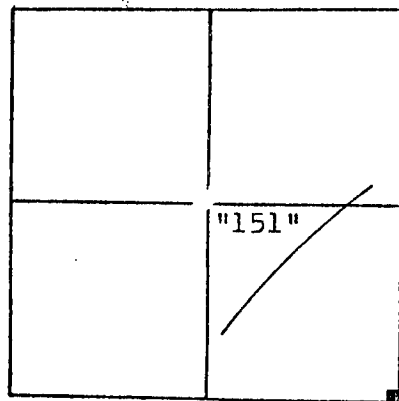

Corner Location
(Indicate by - ■)
State Plane Coordinates
1853740.043 X
243698.516 Y

Tie sketch

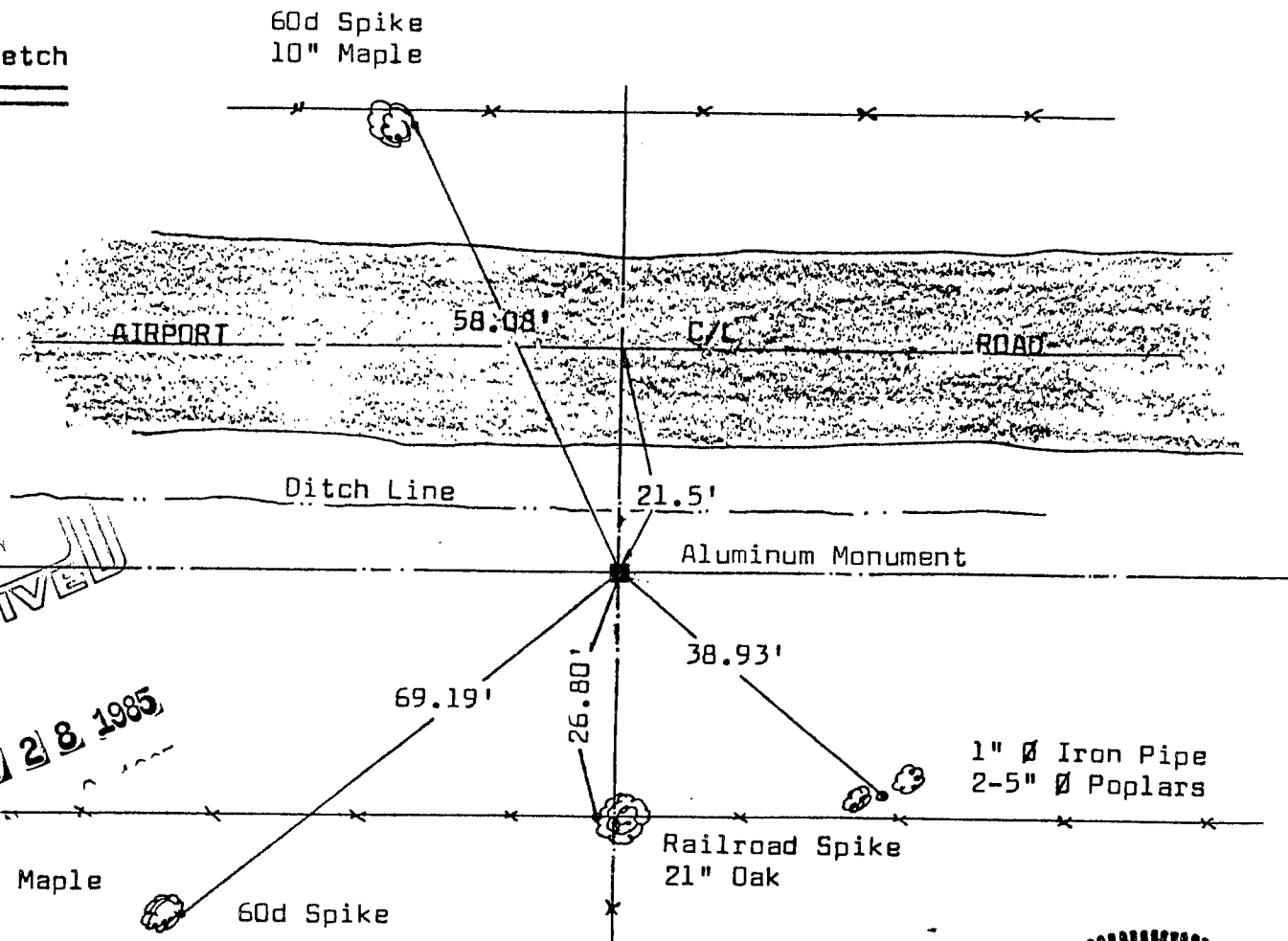

RECEIVED
MAY 28 1985

I, Matthew J. Janiak Certify that the corner location shown hereon this record was determined by me or under my direction and control and that this U. S. Public Land Survey Monument Record is correct and complete to the best of my knowledge and belief.

11-01-84
Date

Matthew J. Janiak
Registered Land Surveyor

