

# GRANT COUNTY

## Survey Monument Record

TYPE OF MONUMENT 7/8" IRON BAR FOUND  
 STATE PLANE COORDINATES: N \_\_\_\_\_  
 E \_\_\_\_\_  
 ELEVATION — M.S.L. DATUM: \_\_\_\_\_  
 THETA ANGLE: \_\_\_\_\_  
 FIELD BOOK: 94-18  
 PAGE: 28

CORNER NO. 56  
 SECTION 17  
 TOWN 2 N  
 RANGE 1 W  
E 1/4 COR.

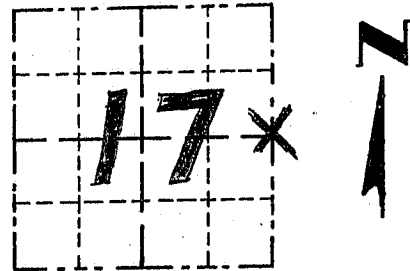

LOCATION  
 (Indicated by "X")

### BASIS FOR MONUMENT LOCATION

(Use reverse side if necessary)

Show info such as: History of corner, with reference to Vol. and pg., dates, surveyor; exact description of monument replaced; if location computed, by taped or EDM traverse; landowner, remarks, etc.

CORNER WAS ORIGINALLY SET IN 1832 BY LUCIUS LYONS; FOUND A 7/8" SOLID BAR AT OCCUPIED LOCATION; I ACCEPTED ITS LOCATION AFTER VERIFICATION BY EDM TRAVERSE.

SEAL:

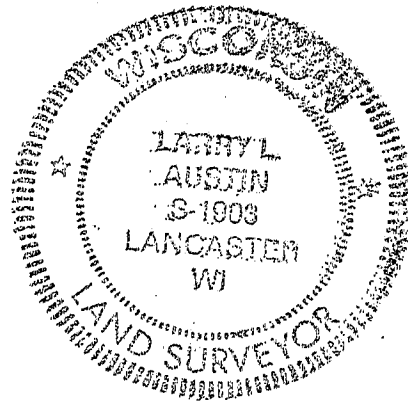

CERTIFIED CORRECT

*Larry L. Austin*  
 Registered Land Surveyor

DATE: 3/9/95

### TIE SKETCH

Show at least three (3) ties and monument

#### LEGEND

- 7/8" IRON BAR FOUND 6" BELOW SURFACE = CORNER
- 1" IRON PIPE SET = TIES
- X — X — EXISTING FENCE

