

RECORD OF U.S. PUBLIC LAND SURVEY CONTROL STATION

QUARTER SECTION CORNER  $\frac{13}{24} \frac{18}{19}$  TOWNSHIP 2 N, RANGE 1 E, Grant Lafayette COUNTY, WISCONSIN

GEODETIC SURVEY BY: \_\_\_\_\_

STATE PLANE COORDINATES OF: \_\_\_\_\_  
 NORTH \_\_\_\_\_  
 EAST \_\_\_\_\_

ELEVATION OF STATION: \_\_\_\_\_ THETA ANGLE: \_\_\_\_\_

HORIZONTAL DATUM: WISCONSIN STATE PLANE COORDINATE SYSTEM, SOUTH ZONE

VERTICAL DATUM: MEAN SEA LEVEL, 1929 ADJUSTMENT

HORIZONTAL & VERTICAL CONTROL ACCURACY: SECOND ORDER

LOCATION SKETCH:

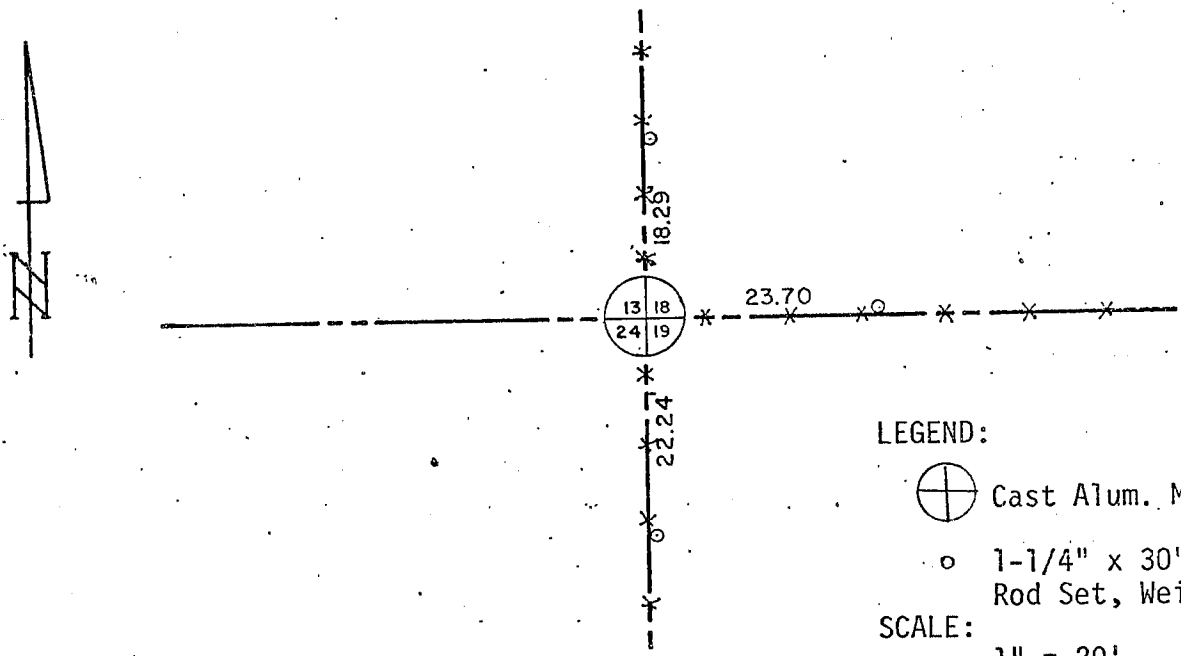
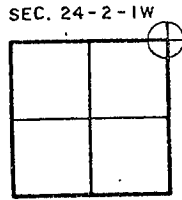

LEGEND:



Cast Alum. Monument Set



1-1/4" x 30" Solid Rd. Iron Rod Set, Weigh. 4.3 Lbs./Lineal Ft.

SCALE:

1" = 20'

SURVEYOR'S AFFIDAVIT:

STATE OF WISCONSIN)  
Green COUNTY) SS

I HEREBY CERTIFY THAT I, Richard D. Talarczyk, have complied with the Wisconsin Statutes, Statutes of the United States, and the rules and regulations made by the Secretary of the Interior in the location of the corner shown above.

DATE OF SURVEY: 8-29-81 to 9-17-81

*Richard D. Talarczyk*  
 Richard D. Talarczyk

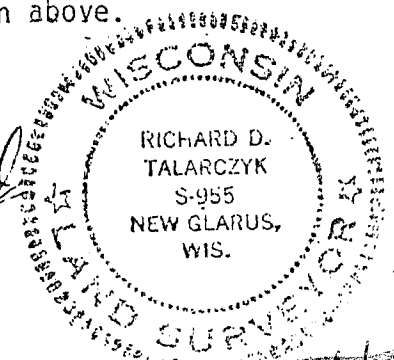

*p. 61*